

**APPENDIX A: PRELIMINARY REDRAWN CREEK VALLEY OVERLAY**

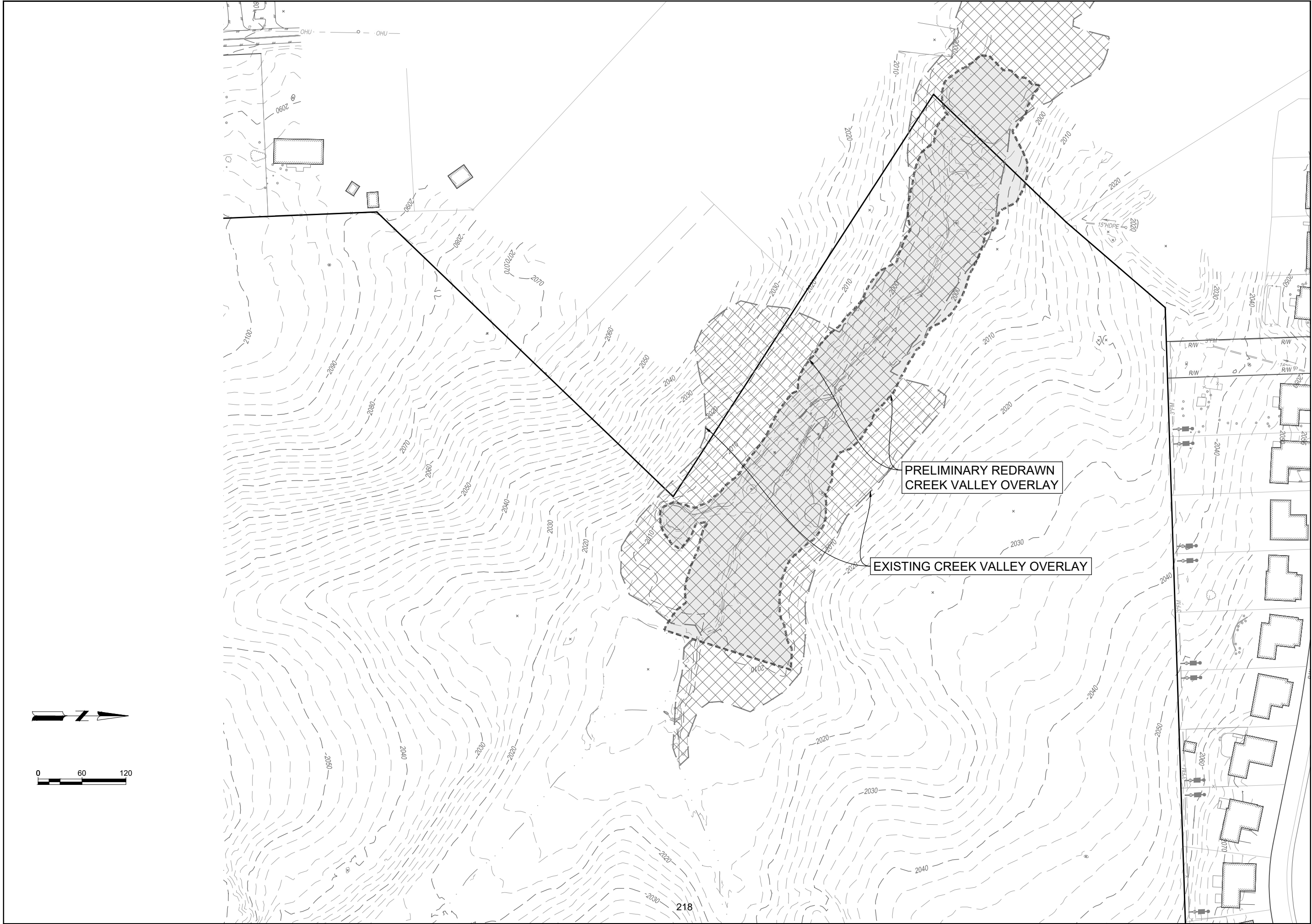

No.	Revision / Issue	Date

**PRELIMINARY**

**PROPOSED CREEK VALLEY  
 OVERLAY MODIFICATION  
 EXHIBIT**

PROPOSED DEVELOPMENT OF  
**GLADE SPRING CROSSING**  
 PROPERTY OF GLADE HGTS, LLC - TAX PARCELS  
 225-(A)-3, 225-(A)-4, & 224-(A)-57 - 45,0976 AC.  
 TOWN OF BLACKSBURG - PRICES FORK DISTRICT  
 MONTGOMERY COUNTY, VIRGINIA

Drawn By: MSF	Scale: AS SHOWN
Checked By: -	Date: 10/31/2022
Sheet No. 1 of 1	1

**EDEN & ASSOCIATES**  
 engineering • planning • development  
 1700 KRAFT DRIVE, SUITE 2350  
 BLACKSBURG, VIRGINIA 24060  
 VOICE 276-632-6231  
 FAX 276-632-3648

