



**BALZER**  
& ASSOCIATES  
PLANNERS / ARCHITECTS  
ENGINEERS / SURVEYORS

80 College Street  
Suite H  
Christiansburg VA 24073  
540.381.4290  
www.balzer.cc

Roanoke  
Richmond  
New River Valley  
Shenandoah Valley

May 25, 2023

Kinsey O'Shea  
Town of Blacksburg  
400 South Main Street  
Blacksburg, VA 24073

RE: AC Hotel Midtown DC-2 CUP - Revisions

Dear Kinsey,

We are providing the following updated documents regarding the above referenced CUP request.

Revisions included are:

- 1) The Building facades have been adjusted based on further discussions with Town Staff and our Planning Commission Work Session Meeting on April 18<sup>th</sup>.

These revisions include:

- Overall appearance of the building and material usage revisions along façades fronting South Main Street and the Commons.
- Building footprint and porte-cochere location have adjusted.
- Redesign of the southern end of the building that faces the Plaza.
- Floor plan layouts have shifted based on the redesign of the southern end of the building.
- Additional details regarding varying setbacks of the building facades.
- Enclosed rooftop area has been reduced and shifted further away from the front façade of the building.
- Enclosed rooftop area has been shifted to the north end of the building and the outdoor area in on the south end.
- Removal of South Main Street balconies and screenwalls.

These updates are best referenced by reviewing the perspective renderings and the elevations in the drawing package.

- 2) As the footprint of the building has changed, the masterplan drawing CUP3 has been revised to show those updates.
- 3) The total number of guest rooms in the hotel has dropped from 155 to 144 rooms.
- 4) Drawing CUP 4 has been added to the plan set. CUP 3 shows uses and detail of the Main Street level portion of the building and CUP 4 shows uses and detail of the Commons level portion of the building.



- 5) The Application text document has been revised as well to include the updated square footage numbers and some slight changes in the dimensioning of the building to site elements such as right of way and back of curb.
- 6) Façade material percentages chart shall be provided prior to Planning Commission Public Hearing.
- 7) Note has been provided on all architectural drawings stating that signage is conceptual only and will be provided in conformance with the Midtown Special Signage District.
- 8) Brick paver pattern has been shown from curb to building along South Main Street.
- 9) Applicant is in agreement to coordinate with the Town staff prior to CUP approval on specific location of street trees and furnishings along South Main Street frontage. Applicant is also in agreement with the condition of additional street furnishings similar to what was approved for DC 6.

Thank you for reviewing this supplemental information and if you have any additional questions or comments, please feel free to contact me.

Sincerely,  
**BALZER AND ASSOCIATES, INC.**

Steven M. Semones  
Executive Vice President

**CONDITIONAL USE PERMIT APPLICATION**

**FOR**

**AC HOTEL  
MIDTOWN DC-2**

**TBD South Main Street  
Blacksburg, Virginia**

**TAX PARCEL  
257-A 94C**

**March 1, 2023  
Revised May 25, 2023**

**PREPARED FOR:  
MIDTOWN REDEVELOPMENT PARTNERS, LLC  
PO Box 10397  
Blacksburg, VA 24062**

**PREPARED BY:  
BALZER & ASSOCIATES, INC.  
80 College Street, Suite H  
Christiansburg, VA 24073**

### ***Description of Proposed Use:***

The site is located on a 1.013 acre portion of the property which fronts South Main Street within the Midtown Project and is owned by Midtown Redevelopment Partners, LLC. This portion of property has been designated Downtown Commercial Parcel #2 (DC-2) in the approved rezoning for the Old Blacksburg Middle School property designated as Ordinance Number 1866 and as amended in Ordinance 1933 and 1968. DC-2 will be located along South Main Street and will also be accessible from the loop road of Old School Common. The proposed use of this DC-2 parcel as provided within the approved rezoning application and Pattern Book is a mixed-use building that may include commercial, office, retail, and residential uses. However, no residential use is proposed but a new use for a hotel is proposed. In order to provide the square footage needed for each proposed use, additional building height above the currently allowed 60 feet will be required for DC-2.

The Pattern Book approved for the Midtown Development allowed for a maximum height of 60 feet in the proposed Downtown Commercial district. The underlying height requirement in the Downtown Commercial district is also 60 feet. The Town zoning ordinance defines building height as “The vertical distance measured from the adjoining grade at the front entrance of the building or structure to the highest point of the structure. For corner lots, the building height shall be the average of the front height defined above and the building side height adjacent to the street. The building side height shall be defined as the vertical distance measured from the lowest adjoining grade on the side adjacent to the street to the highest point of the structure.” However, the approved Pattern Book states that building height for DC-2 shall be measured from The Commons side of the building and not from South Main Street. This was done knowing that there would a grade drop between the Commons and South Main Street and that the South Main level of the building would be built into the grade creating a lower level walkout like condition.

The current building design for DC-2 is an “L” shaped mixed use building with a total gross enclosed area of approximately 142,943 square feet. The long leg of the building that runs parallel to South Main Street would be a maximum of seven stories and the short leg of the building running perpendicular to South Main Street would be three stories. Uses would include approximately 20,760 square feet for allowable commercial uses such as, but not limited to, retail, restaurant, and the hotel lobby (approximately 531 sf) on the ground floor that is accessed from South Main Street. The second floor which is accessed from The Commons, would be Hotel use including check in, hotel amenity areas and 5 hotel rooms. The third floor would have 22 hotel rooms and 12,812 square feet of office space. Floors four, five and six are all programed as hotel rooms with 39 rooms per floor. The seventh floor would provide an 8,749 square foot enclosed rooftop lounge, of which 2,272 square feet is a meeting room. A large outdoor patio area is also included on the roof level. As design was finalized on the building, it was determined that the maximum building height as measured from Old Town Common would be approximately 75 feet, thus 15 feet taller than currently allowed. The request of this Conditional Use Permit is for a 144 room Hotel Use in the DC district and a maximum building height of 75 feet for DC parcel 2.

When evaluating an additional height increase in the Downtown Commercial zoning district, the following criteria are reviewed:

*(1) Whether the parcel has frontage on a Major Arterial roadway*

- DC Parcel 2 does have frontage on South Main Street which is considered a Major Arterial.

*(2) The parcel is not located within two hundred fifty (250) feet of any parcel zoned R-4, R-5 or OTR*

- As shown on the attached drawing labeled CUP 1, the property is located within 250 feet from R-5 zoned property. These R-5 properties are located across South Main Street from the Midtown Development. These properties however are primarily commercial offices along with one Fraternity house at the corner of South Main and Eheart Street. There are also R-5 properties on Eheart Street but they will be buffered from this building by the structure proposed on Parcel DC-4.

*(3) Relationship of building to the street*

- The building proposed addresses South Main Street as its main frontage and it also addresses the internal access road that loops around The Commons. The lowest floor which fronts South Main Street is proposed as entirely commercial use which could be retail, restaurant or office as allowed within the Pattern Book. As such, there will be multiple doors and potential usable outdoor area in front of these spaces to allow for outdoor retail display, outdoor dining, etc. as allowed by Town Code and the Pattern Book. While the Hotel will have a small entry/lobby area on the ground floor, the main check-in area and support services will be on the second floor and accessed from the internal loop road of The Commons. The proposed building has varying setbacks from the back of curb of the South Main Street from 29 feet – 35 feet due to the building articulation. Based on these factors, the additional 15 feet of proposed building height will not negatively impact the building to street relationship.

*(4) Building mass, scale, architectural features, which should include expression lines or other horizontal building articulation, and step backs for stories above sixty (60) feet in height.*

- The majority of the building mass is located along South Main Street. The Pattern Book and previous concept plans have always envisioned a signature building paralleling South Main frontage that addresses the street with significant commercial space on the ground floor. Only one half of the building reaches the requested 75 foot height and is on the left end of the building as viewed from South Main Street. The right end of the building is stepped down at a height of approximately 62 feet. There are several additional step backs in the building façade facing South Main Street, both at ground level and as you move up to the fourth floor and again on the seventh floor. The building also has several different materials proposed that break up the façade of the building both horizontally and vertically, particularly on the South Main Street façade portion of the building as shown in the attached drawings. The scale and height of the building itself is in keeping with the other multi-use building, hotel and public safety building proposed within Midtown in both architectural character and materiality as well as height.

*(5) Building setbacks*

- The building setbacks were determined and specified as part of the rezoning application and accompanying Pattern Book. The minimum required building setback from South Main Street

for DC zoned parcels is 20 feet. This allows for the downtown standard sidewalk section as well as keeping additional area for potential outdoor seating and dining opportunities for uses within the DC-2 building. There are no side or rear setback requirements for this parcel. The proposed building is setback 21-23 feet from the South Main Street right of way line to the column features. However, the actual doors along the main face of the building are inset another 4' from the column line where the dimensions above are taken. As you go up to the the fourth floor, there is 4'6" additional setback to break up the façade of the building. At the upper seventh floor level, the step back of the building is 11'6" from the ground floor façade. There is also between 15-17 feet from the property adjacent to Clay Court, between 8-10 feet from the property line adjacent to the Plaza, 7 feet to the property line adjacent to the Town Public Safety Building and approximately 28 feet to the property line adjacent to the Common's loop road parking area.

*(6) Width of sidewalk*

- The sidewalk along the South Main Street frontage of DC-2 is very wide based on the approved Pattern Book and the actual placement and design of the building itself. A minimum sidewalk width of 20 feet from the right of way line was proposed along South Main Street in the Pattern Book. The proposal shows a minimum of 21 feet to the building at the closest point and then widens generally to 23 feet. When you include the additional 8 feet of sidewalk from the right of way line to the back of curb, the actual usable sidewalk ranges from 29 feet to 31 feet wide. To the south of the building is the Plaza at the corner of Eheart Street and South Main Street where there is pedestrian access to The Commons and the rest of the Midtown development. There will also be sidewalks which are internal to the site, and private, ranging between 5 feet and 24 feet in width.

*(7) Impact on pedestrian environment*

- As described in #6, there is a very wide sidewalk along South Main Street in front of this building to provide ample space for pedestrians. The building articulation and varying setbacks also aid in not creating a "tunnel" affect as you travel this section of sidewalk. The additional height requested with this CUP does not negatively impact the pedestrian environment of South Main Street or of the Midtown Development.

*(8) Impact on adjacent land uses.*

- The Midtown Development is a mixed use development that has commercial, residential, hotel, restaurant and public use buildings and uses proposed for the site. All uses onsite in the DC district were originally proposed for a 60' height. However, three buildings have requested and been granted a CUP for additional height. These buildings were the DC-1 Parcel Town Public Safety Building and Parking Garage (76'), DC-5 Parcel mixed use building (70'), and the DC-6 Parcel Hotel (73'). The adjacent use of Clay Court is a three story building with a sloped roof and an approximate total height of 50' from South Main Street. Any new building constructed at a four-story height and/or to the DC district maximum of 60' or above would have the same impact on that existing building so the additional requested height will create no additional negative impact on Clay Court. A portion of this building adjacent to Clay Court is also only a two story height (28') from the Commons. This would limit impact on the rear third of Clay Court. The section of the building closest to Midtown Plaza is only a six story height as the enclosed seventh floor meeting space is on the north end of the building. This lessens the perceived height impact on the Plaza. As per the Pattern Book, DC-2 height is measured from

the Commons and not South Main Street. With these minimal heights over the allowable 60' and the setbacks proposed, no negative impact on adjacent land uses are anticipated with this request.

***Please demonstrate how the proposed use, when complemented with additional measures, if any, will be in harmony with the purposes of the specific district in which it will be placed:***

Mixed use development is a guiding feature of Midtown and this DC-2 building addresses those goals by providing the opportunity for a mix of retail, restaurant, office, hospitality, community meeting space and outdoor enjoyment. The additional request for a Hotel use will provide another option for visitors to Blacksburg to stay in the heart of Town and provide additional revenue support to the downtown local business and restaurants. The hotelier has embraced the ground floor commercial concept and also included just under 13,000 square feet of office space which was also envisioned for this particular location in Midtown. The outdoor terrace area and the meeting room space on the upper level will provide opportunities for building users and the community to experience Midtown and the views of Town. The hotel use or the additional 15-foot height increase that is being requested does not in any way detract from or alter the overall development patterns or design intent of Midtown or the Downtown Commercial District.

***Please demonstrate how there will be no undue adverse impacts on the surrounding neighborhood in terms of public health, safety, or general welfare, and show the measures to be taken to achieve such goal:***

As stated above, no adverse impact to the surrounding neighborhood is anticipated with the Hotel Use or with the additional 15 feet of height proposed on DC-2. Wide, pedestrian friendly sidewalks are planned along the South Main Street frontage and the majority of the non-commercial uses above the ground floor such as the Hotel will be primarily using the Commons side entry. Traffic impacts, stormwater management, utility infrastructure capacity has been planned for and determined adequate as part of the overall Midtown Rezoning process. All vehicular traffic will be directed internally to the Midtown development and no curb cuts are proposed along South Main Street. The proposed use and height requested with this CUP will not adversely impact those items. Site standards for parking, landscaping, access, etc. will be in accordance with the guiding documents of the Midtown rezoning.

***Any modifications or exceptions to Use and Design Standards or Development Standards must also be requested at the time of CUP evaluation. Identify and provide a justification for modification/exception.:***

As the property is zoned DC-Downtown Commercial with the Midtown development, there are no modifications or exceptions to the Use and Design Standards or the Development Standards with this CUP application. The only Use and Design Standards for Hotel/Motel are listed below. The proposed project does meet these two standards.

Sec. 4528.2 - Hotel/motel.

Additional standards in the MXD, DC and GC zoning districts:

(1) Parking will be located behind the front line of the principal building. Town Council may grant a special exception to this requirement as authorized by Section 1112.

(2) A hotel/motel cannot consist of a single ground floor of hotel/motel use with all other floors used for multi-family development. At least fifty (50) percent of the building's total square footage must be a hotel/motel use.

***If the application is an amendment to an existing approved S/CUP, provide an identification of any proposed changes requested below and on a plan, and strike-through and italic edit of any conditions proposed to be changed:***

This application is not amending an existing approved S/CUP.

**Other design elements of DC-2 as shown on the submitted Masterplan Sheets CUP 3 & CUP 4:**

- Trash and recycling shall be stored inside the building thus completely screened from the public view. Pickup will occur from the The Commons loop road.
- All HVAC units shall be located on the roof of the proposed building and screened as necessary.
- The sidewalk along South Main Street shall meet all Downtown sidewalk design standards including street trees, street furniture, street lights, brick pattern, etc. as noted in the Pattern Book.
- The original loop road parking layout adjacent to this parcel has been adjusted to account for the Hotel's porte-cochere. A total of 7 parking spaces were removed.
- Total Parking Allocation for DC-2 = 230 spaces
  - Garage Parking Spaces Remaining for DC-2 = 165
  - The Commons Loop Road Parking Spaces for DC-2 = 65



**AC HOTEL – MIDTOWN DC-2  
CONDITIONAL USE PERMIT**

Adjacent Property Owners

<b>Tax Parcel(s)</b>	<b>Owner</b>	<b>Address</b>
257-A218 257-3SEC 1A, F	TOWN OF BLACKSBURG	300 SOUTH MAIN STREET BLACKSBURG, VA 24060
257-A 94D 257-A94A	MIDTOWN REDEVELOPMENT PARTNERS, LLC	PO BOX 10397 BLACKSBURG, VA 24062
257-B 1 C	SOUTH MAIN 500 OWNERS ASSOCIATION	NONE PROVIDED ON GIS
257-B 1 6, 7, 8	506 SOUTH MAIN LLC	506 SOUTH MAIN ST BLACKSBURG, VA 24060
257-B 1 3, 4, 5	BOXWOOD DEVELOPMENT LLC	1506 BOXWOOD DRIVE BLACKSBURG, VA 24060
257-B 1 1, 2, A	SNYDER LAND TRUST	2220 WOODLAND HILLS DR BLACKSBURG, VA 24060
257-C 1A	HILL COMPANIES LLC	401 SOUTH MAIN STREET BLACKSBURG, VA 24060
257-C 1C	CLAY COURT CONDO ASSOCIATION	401 SOUTH MAIN STREET BLACKSBURG, VA 24060
257-C 1106	FMS COMBINE LLC	907 HORSESHOE LANE BLACKSBURG, VA 24060
257-C 1214	JOYFULL LLC	21548 LAKE POINT LANE CORNELIUS, NC 28031

257-C 1314	CLAY COURT 314 ASSOCIATES LLC	5501 MERCHANTS VIEW SQUARE 729 HAYMARKET, VA 20169
257-C 1216	TODD AND KERRY DOFFLEMYER	14312 CHARTER WALK LANE MIDLOTHIAN, VA 23114
257-C 1218	MELANIE SONTHEIMER	401 SOUTH MAIN STREET UNIT 218 BLACKSBURG, VA 24060
257-C 1220	STEVEN AND WENDELIN HUYBRECHTS	401 SOUTH MAIN STREET UNIT 220 BLACKSBURG, VA 24060
257-C 1222	CHARSKY ENTERPRISES LP	8628 CHARLES WACK STREET MANASSAS, VA 20112

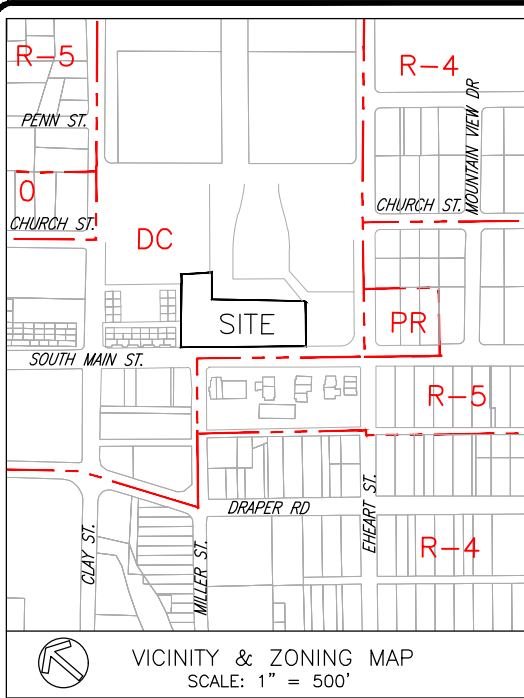

N/F  
TOWN OF BLACKSBURG  
INST. #2020009960  
INST. #2020009951  
(PARCEL A)  
TAX MAP #257-A-218  
PARCEL ID #170059  
ZONED: DC

N/F  
MIDTOWN  
REDEVELOPMENT  
PARTNERS, LLC  
PORTION OF TAX MAP  
#257-A-94D  
PORTION OF PARCEL  
ID #280057

① N/F  
CHARSKY ENTERPRISES LP  
ZONING: DC  
TAX MAP #257-C 1222  
PARCEL ID #130212

④ N/F  
TODD & KERRY DOFFLEMYER  
ZONING: DC  
TAX MAP #257-C 1216  
PARCEL ID #130209

⑦ N/F  
FMS COMBINE LLC  
ZONING: DC  
TAX MAP #257-C 1106  
PARCEL ID #120719

⑩ N/F  
SOUTH MAIN 500 OWNERS  
ASSOCIATION  
ZONING: DC  
TAX MAP #257-B 1 C  
PARCEL ID #027836

② N/F  
STEVEN & WENDELIN HUYBRECHTS  
ZONING: DC  
TAX MAP #257-C 1220  
PARCEL ID #130211

⑤ N/F  
CLAY COURT 314 ASSOCIATES LLC  
ZONING: DC  
TAX MAP #257-C 1314  
PARCEL ID #120735

⑧ N/F  
HILL COMPANIES LLC  
ZONING: DC  
TAX MAP #257-C 1A  
PARCEL ID #120736

③ N/F  
MELANIE SONTHEIMER  
ZONING: DC  
TAX MAP #257-C 1218  
PARCEL ID #130210

⑥ N/F  
JOYFUL LLC  
ZONING: DC  
TAX MAP #257-C 1214  
PARCEL ID #120727

⑨ N/F  
CLAY COURT CONDO  
ASSOCIATION  
ZONING: DC  
TAX MAP #257-C 1C  
PARCEL ID #120737

N/F  
MIDTOWN REDEVELOPMENT PARTNERS, LLC  
PORTION OF TAX MAP #257-A-94E  
PORTION OF PARCEL ID #280058

N/F  
MIDTOWN  
REDEVELOPMENT  
PARTNERS, LLC  
INST. #2022000571  
PORTION OF TAX MAP  
#257-A-94C  
PORTION OF PARCEL  
ID #280056

N/F  
MIDTOWN  
REDEVELOPMENT  
PARTNERS, LLC  
PORTION OF TAX MAP  
#257-A-94A  
PORTION OF PARCEL  
ID #230165

N/F  
100 EHEART LLC  
ZONING: R-5  
TAX MAP #257-4SEC  
1, 1, 2  
PARCEL ID #002695

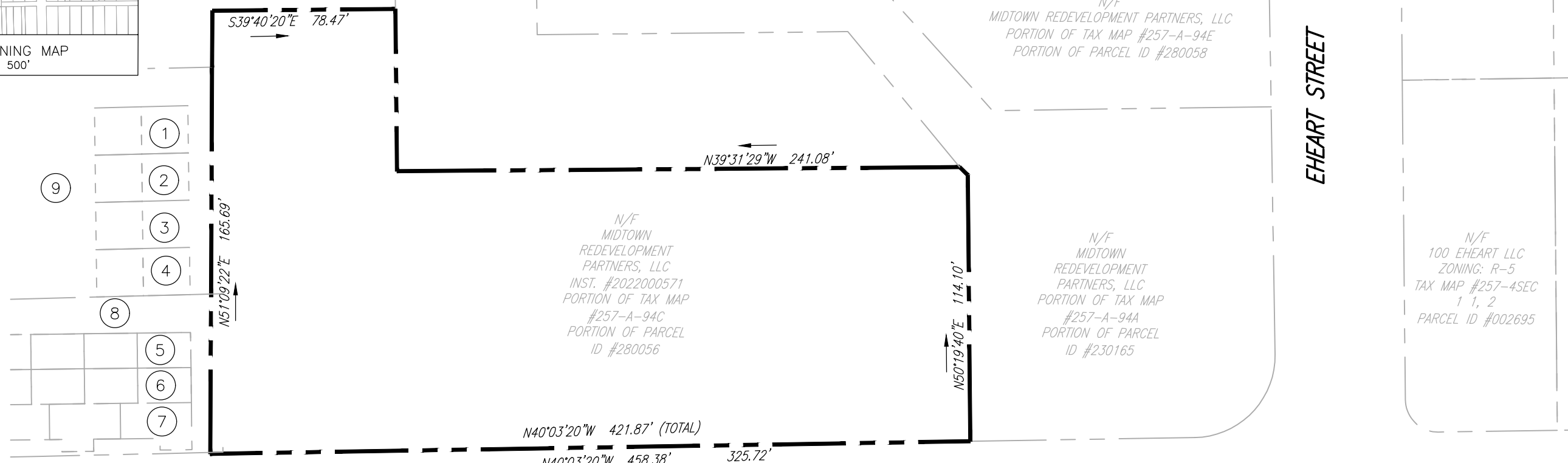

N/F  
TOWN OF BLACKSBURG  
ZONING: DC  
TAX MAP #257-3SEC 1 A,  
PARCEL ID #001908

MILLER STREET

N/F  
SNYDER LAND TRUST, C/O  
GEORGIA ANNE SNYDER FALKINHAM  
TRS  
ZONING: R-5  
TAX MAP 257-B 1, 1, 2, A  
PARCEL ID #027834

N/F  
BOXWOOD DEVELOPMENT LLC, C/O  
JOHN W SPICER MANAGER  
ZONING: R-5  
TAX MAP #257-B 1, 3, 4, 5  
PARCEL ID #027823

N/F  
506 SOUTH MAIN LLC.  
ZONING: R-5  
TAX MAP #257-B 1, 6, 7, 8  
PARCEL ID #027827

N/F  
TRISON PROPERTIES  
LLC  
ZONING: R-5  
TAX MAP #257-B 1,  
10  
PARCEL ID #027830

N/F  
SNYDER LAND TRUST,  
C/O GEORGIA ANNE  
SNYDER FALKINHAM TRS  
ZONING: R-5  
TAX MAP 257-B 1, 1, 3  
PARCEL ID #027833

N/F  
EPSILON HEXATON ALUMNI FOUND,  
C/O JOE JARBOE  
ZONING: R-5  
TAX MAP #257-3SEC 3, 1, 4  
PARCEL ID #006142

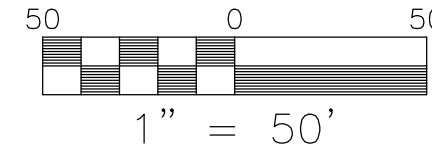

**BALZER & ASSOCIATES**  
PLANNERS / ARCHITECTS  
ENGINEERS / SURVEYORS

Roanoke / Richmond  
New River Valley  
Shenandoah Valley

[www.balzer.cc](http://www.balzer.cc)

80 College Street  
Suite H  
Christiansburg, VA 24073  
540.381.4290

**AC HOTEL - MIDTOWN DC-2**

**OVERALL EXISTING CONDITIONS**

MOUNT TABOR MAGISTERIAL DISTRICT, MONTEGOMERY COUNTY  
TOWN OF BLACKSBURG, VIRGINIA

DATE 3/1/2023  
SCALE 1" = 50'  
REVISIONS  
4/3/2023  
5/25/2023

**CUP 1**

PROJECT NO 24230006.00



**BALZER & ASSOCIATES**  
 PLANNERS / ARCHITECTS  
 ENGINEERS / SURVEYORS

Roanoke / Richmond  
 New River Valley  
 Shenandoah Valley

[www.balzer.cc](http://www.balzer.cc)

80 College Street  
 Suite H  
 Christiansburg, VA 24073  
 540.381.4290

**AC HOTEL - MIDTOWN DC-2**

**EXISTING CONDITIONS**

MOUNT TABOR MAGISTERIAL DISTRICT, MONTGOMERY COUNTY  
 TOWN OF BLACKSBURG, VIRGINIA

DATE 3/1/2023  
 SCALE 1" = 40'  
 REVISIONS  
 4/3/2023  
 5/25/2023

**CUP 2**  
 PROJECT NO 24230006.00

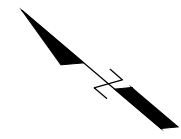
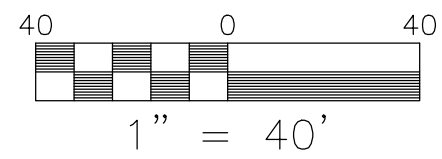
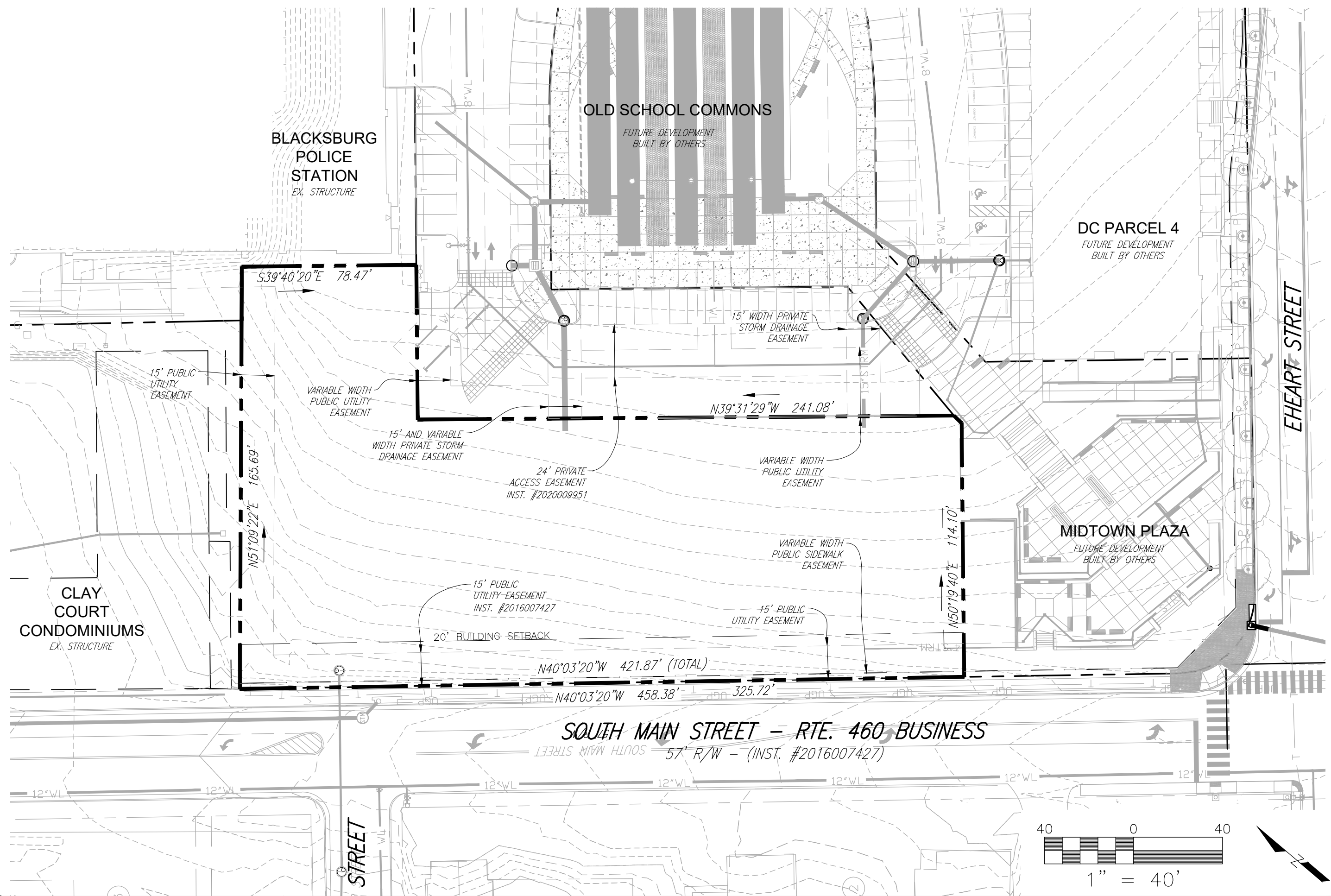

**NOTES:**

1. REAR FACING COMMONS LANDSCAPE FOR ILLUSTRATIVE PURPOSES ONLY. PLANT QUANTITIES, SPECIES AND PLACEMENT TO BE DESIGNED AT A LATER DATE.

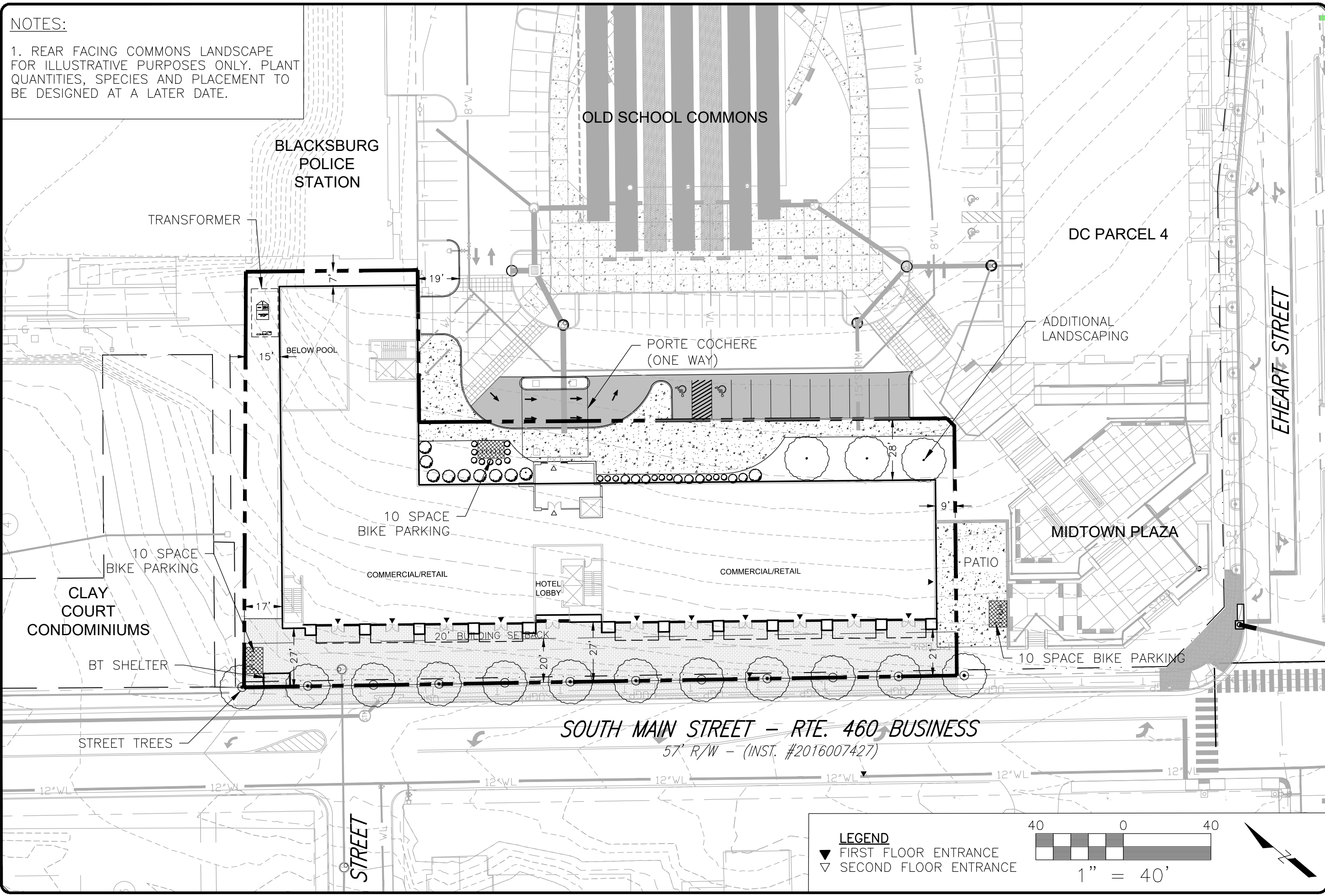

**BALZER & ASSOCIATES**  
 PLANNERS / ARCHITECTS  
 ENGINEERS / SURVEYORS

Roanoke / Richmond  
 New River Valley  
 Shenandoah Valley  
**www.balzer.cc**  
 80 College Street  
 Suite H  
 Christiansburg, VA 24073  
 540.381.4290

**AC HOTEL - MIDTOWN DC-2**

**MASTERPLAN - MAIN STREET LEVEL**

MOUNT TABOR MAGISTERIAL DISTRICT, MONTGOMERY COUNTY  
 TOWN OF BLACKSBURG, VIRGINIA

DATE 3/1/2023  
 SCALE 1" = 40'  
 REVISIONS  
 4/3/2023  
 5/25/2023

**LEGEND**  
 ▼ FIRST FLOOR ENTRANCE  
 ▽ SECOND FLOOR ENTRANCE

**CUP 3**  
 PROJECT NO 24230006.00

**NOTES:**

1. REAR FACING COMMONS LANDSCAPE FOR ILLUSTRATIVE PURPOSES ONLY. PLANT QUANTITIES, SPECIES AND PLACEMENT TO BE DESIGNED AT A LATER DATE.

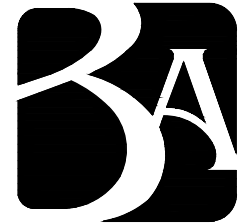
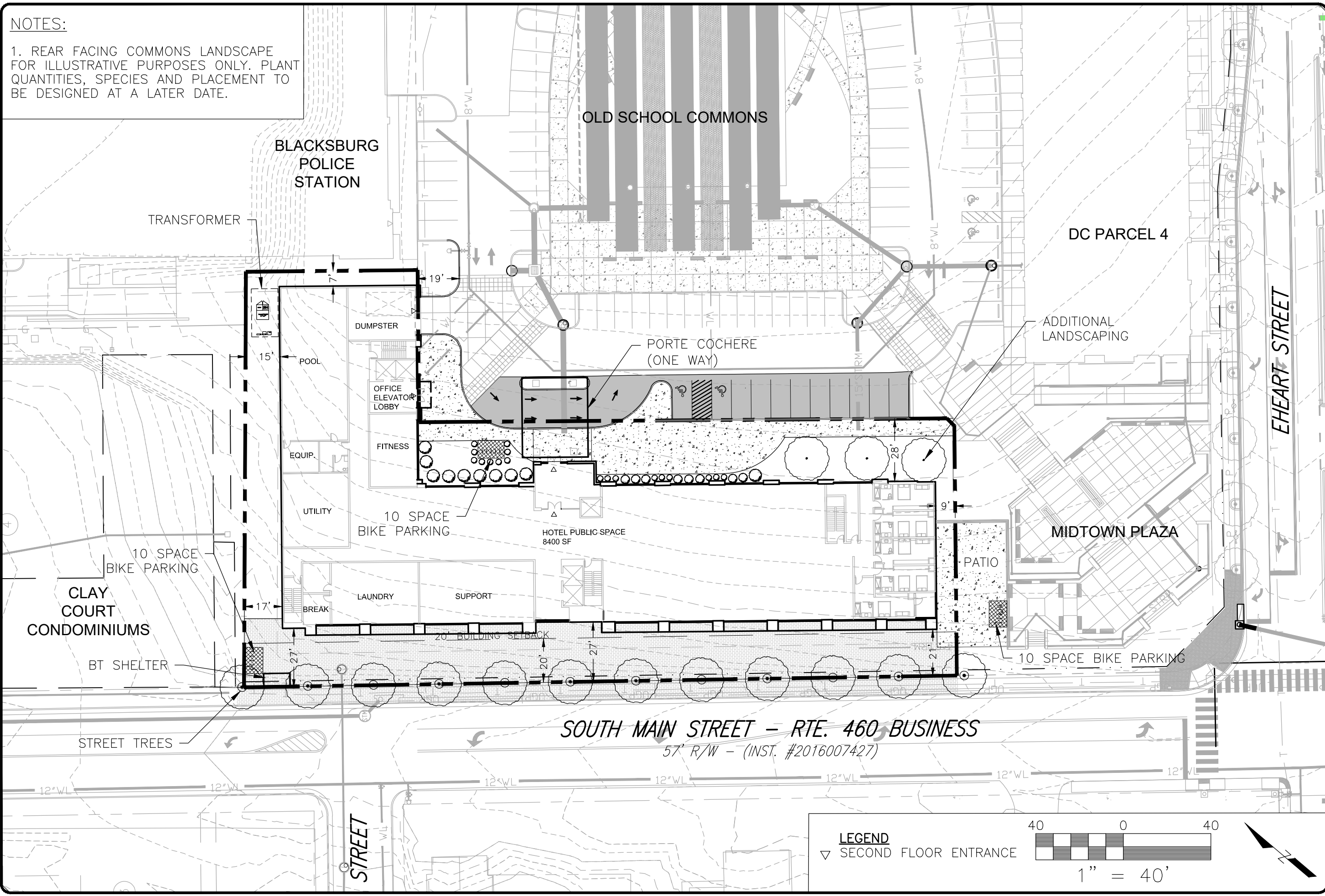

**BALZER & ASSOCIATES**  
 PLANNERS / ARCHITECTS  
 ENGINEERS / SURVEYORS

Roanoke / Richmond  
 New River Valley  
 Shenandoah Valley  
**www.balzer.cc**  
 80 College Street  
 Suite H  
 Christiansburg, VA 24073  
 540.381.4290

**AC HOTEL - MIDTOWN DC-2**  
**MASTERPLAN - OLD SCHOOL COMMONS LEVEL**

MOUNT TABOR MAGISTERIAL DISTRICT, MONTGOMERY COUNTY  
 TOWN OF BLACKSBURG, VIRGINIA

DATE 3/1/2023  
 SCALE 1" = 40'  
 REVISIONS  
 4/3/2023  
 5/25/2023

**LEGEND**  
 ▽ SECOND FLOOR ENTRANCE

**CUP 4**  
 PROJECT NO 24230006.00

The drawings are illustrative of character and design intent only, and are subject to change based upon final design considerations.

Signage as shown hereon is conceptual only. Final signage shall be in conformance with the Midtown Special Signage District.



**AC HOTEL**  
BLACKSBURG, VIRGINIA  
MAY 25, 2023



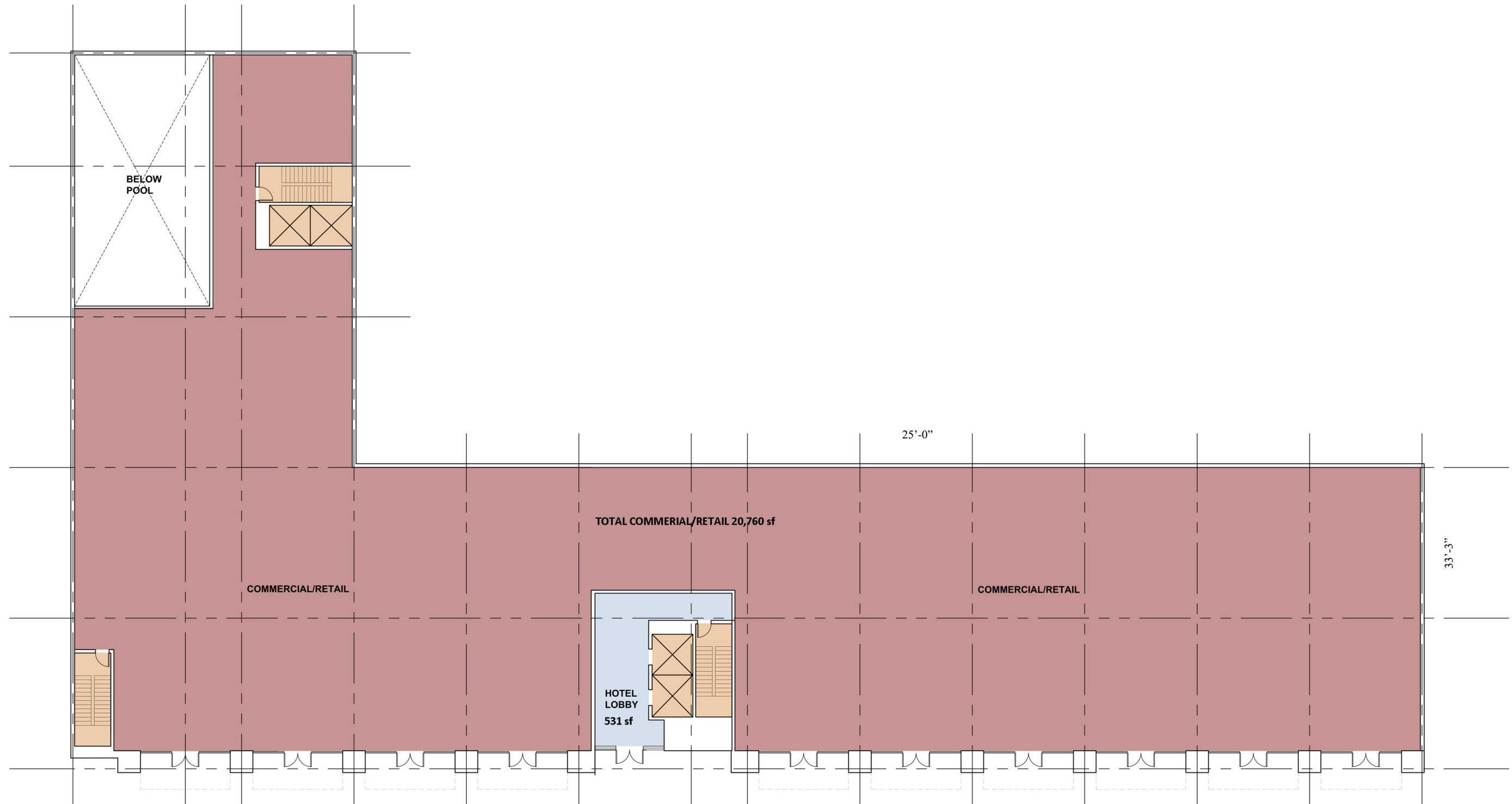

FIRST FLOOR PLAN

TOTAL ROOMS: 144 ROOMS  
68 KING ROOMS  
68 QQ ROOMS  
4 ADA KING ROOMS  
4 ADA QQ ROOMS

TOTAL: 26,112 SF  
GUESTROOMS: 0



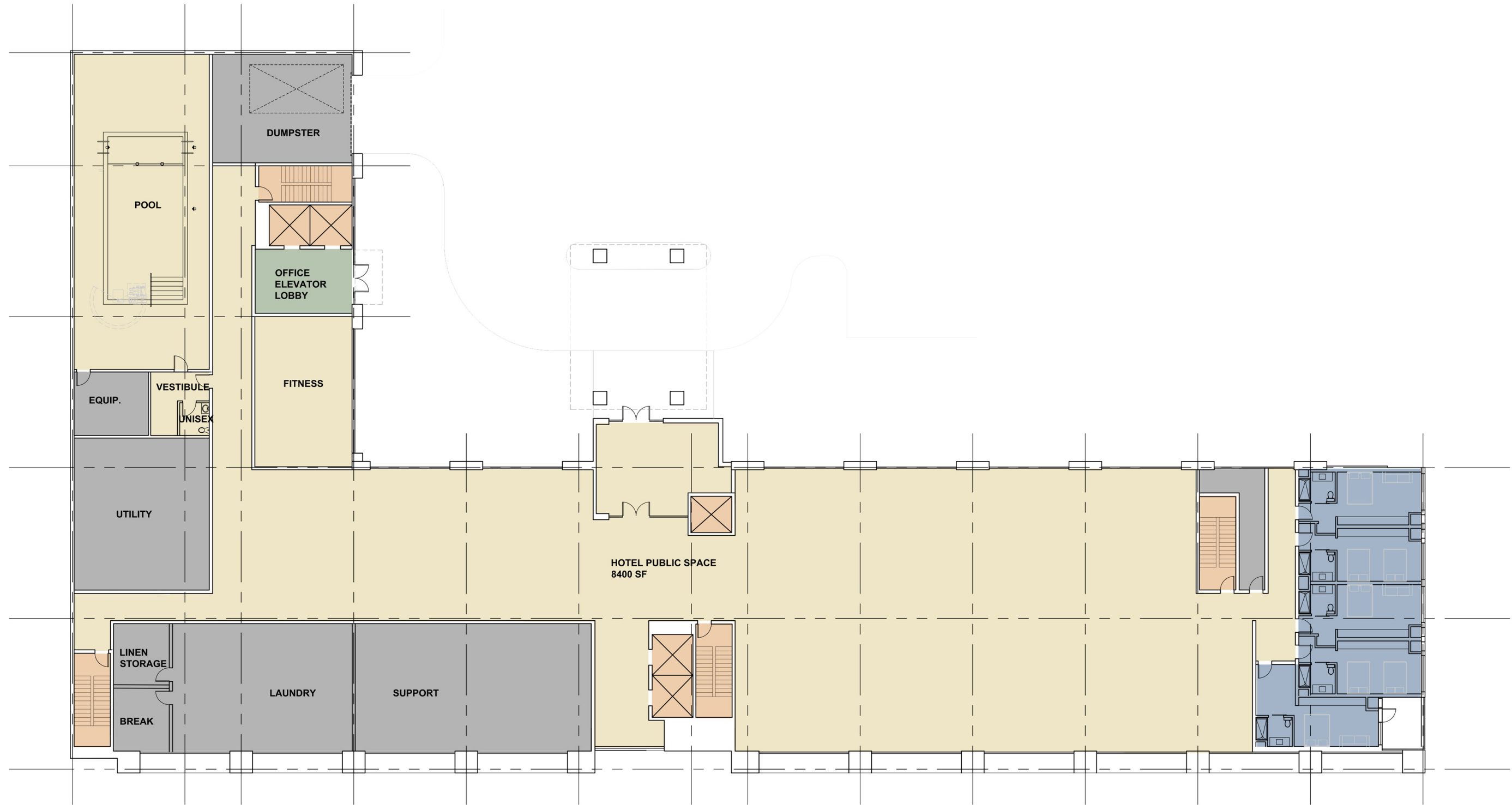

SECOND FLOOR PLAN

TOTAL: 26,615 SF  
GUESTROOMS: 5

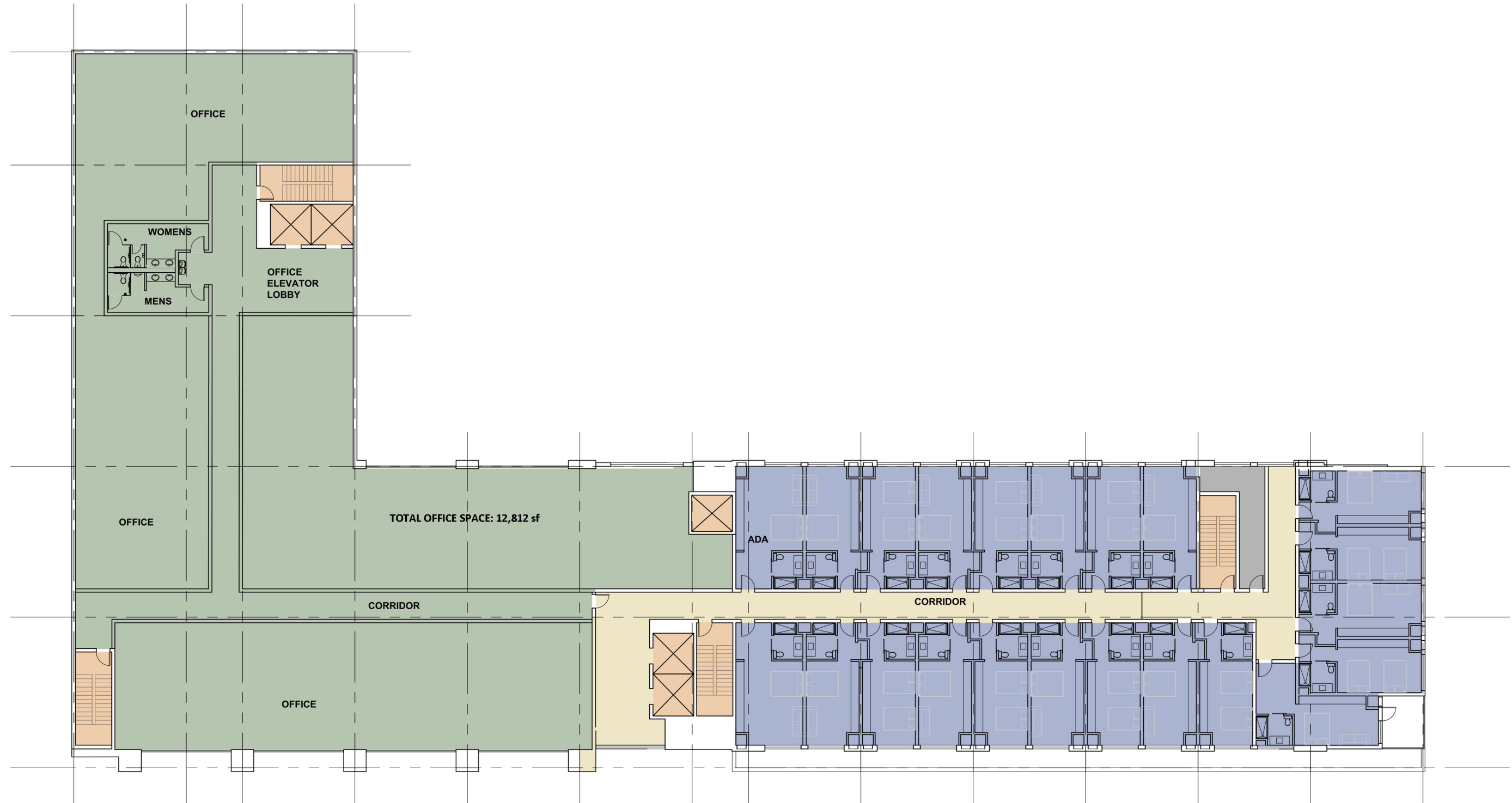

THIRD FLOOR PLAN

TOTAL: 25,249 SF  
GUESTROOMS: 22

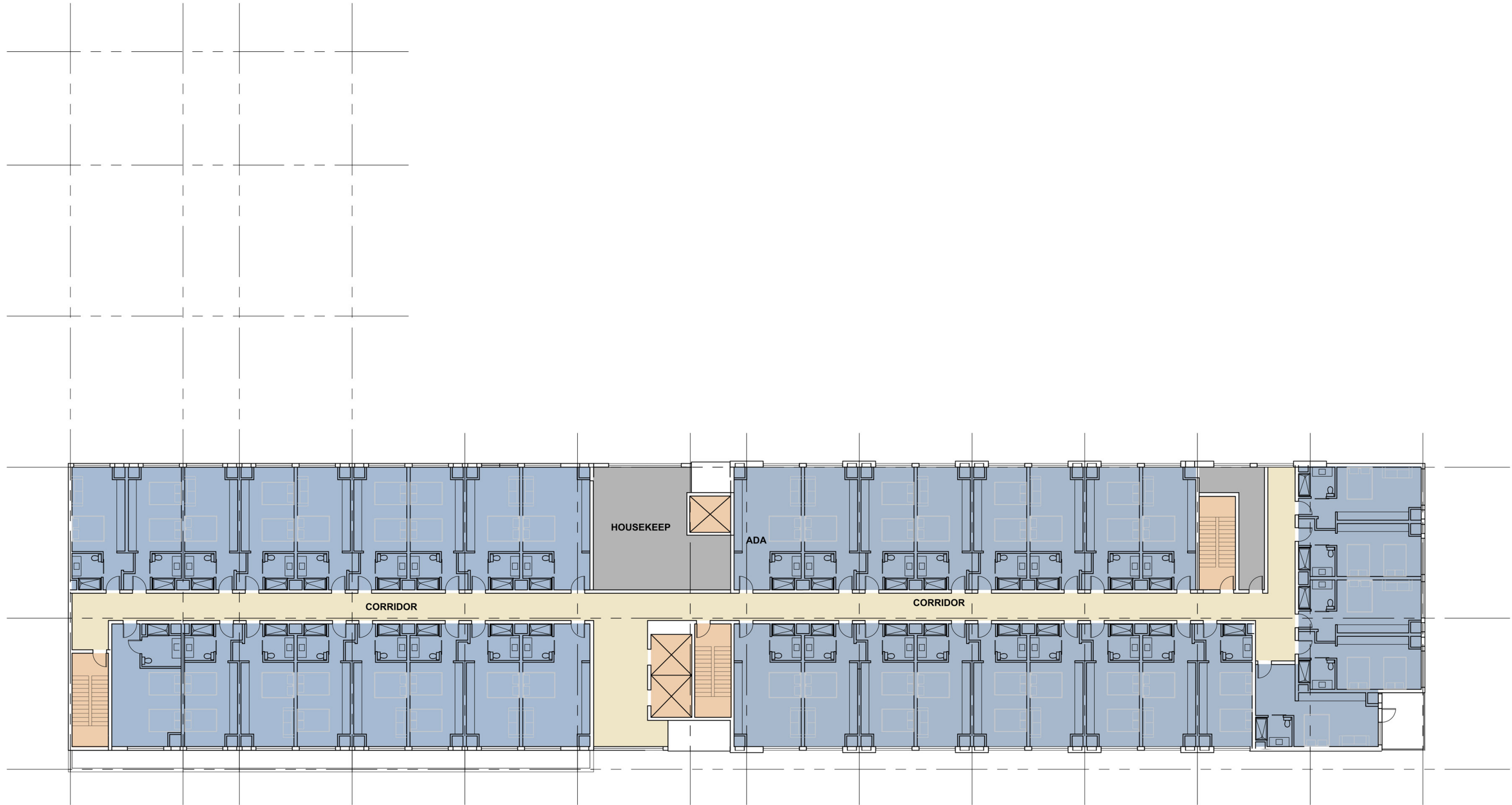

FOURTH - SIXTH FLOOR PLAN

TOTAL: 18,907 SF  
GUESTROOMS: 39

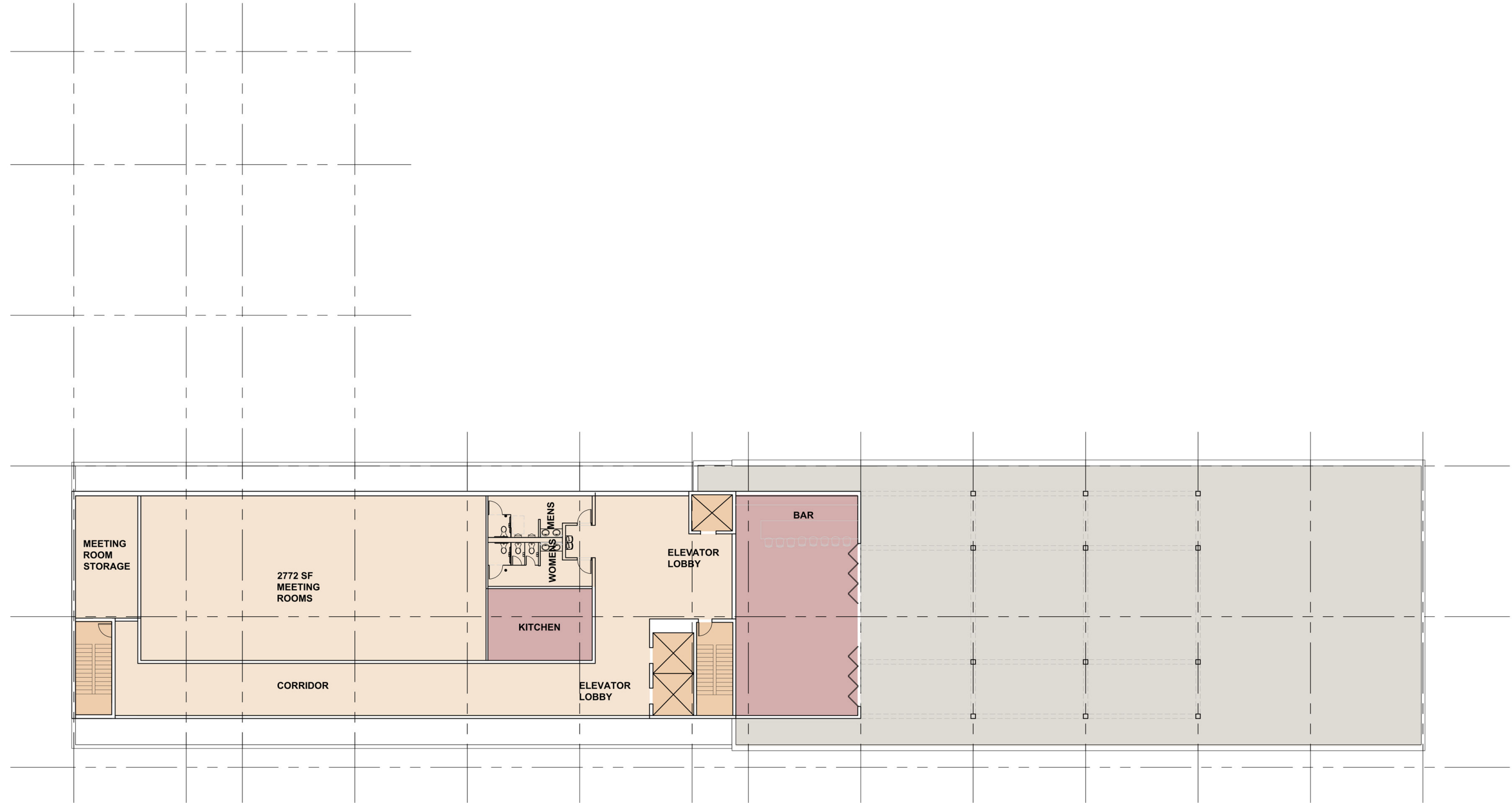

SEVENTH FLOOR PLAN

TOTAL: 8,749 SF  
GUESTROOMS: 0



BUILDING ELEVATION - SOUTH MAIN STREET

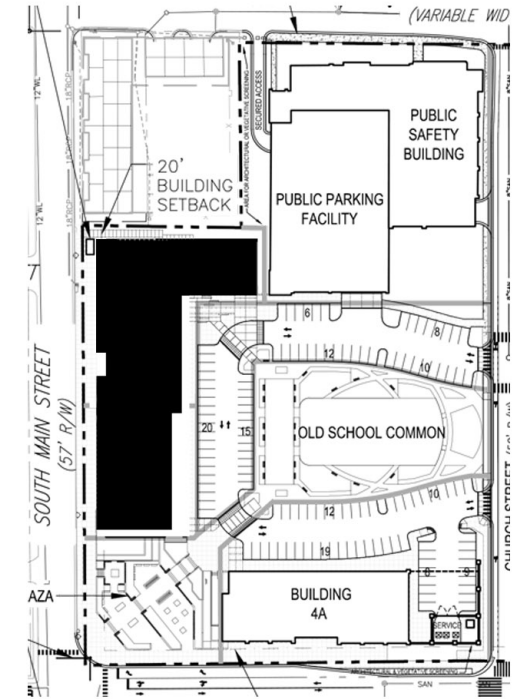

BUILDING ELEVATION - NORTHEAST

-  BRICK
-  BRICK 2
-  METAL PANEL - 1
-  METAL PANEL - 2
-  METAL PANEL - 3



BUILDING ELEVATION - PARKING

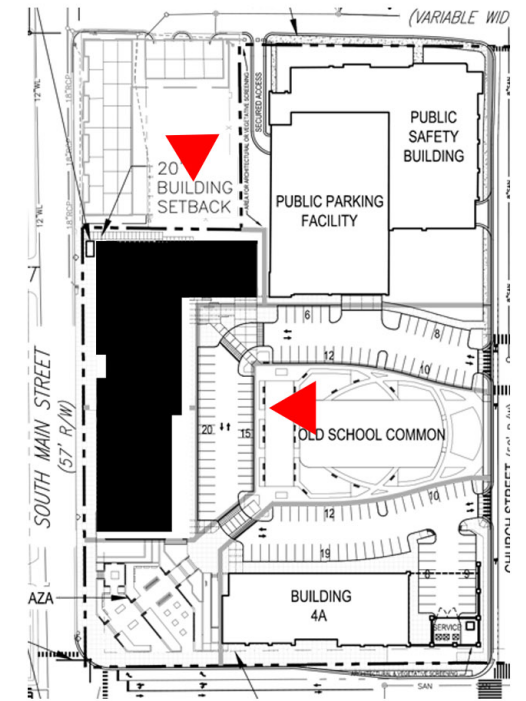

BUILDING ELEVATION - SOUTHWEST

-  BRICK
-  BRICK 2
-  METAL PANEL - 1
-  METAL PANEL - 2
-  METAL PANEL - 3

The drawings are illustrative of character and design intent only, and are subject to change based upon final design considerations.

Signage as shown hereon is conceptual only. Final signage shall be in conformance with the Midtown Special Signage District.



**AC HOTEL**  
BLACKSBURG, VIRGINIA  
MAY 25, 2023



The drawings are illustrative of character and design intent only, and are subject to change based upon final design considerations

Signage as shown hereon is conceptual only. Final signage shall be in conformance with the Midtown Special Signage District.



**AC HOTEL**  
BLACKSBURG, VIRGINIA  
MAY 25, 2023

