

THIS MAP IS A COMPILATION OF RECORD DEEDS, PLATS, AND MAPS OF RECORD AND DOES NOT REPRESENT A BOUNDARY SURVEY. AREAS, BEARINGS, AND DISTANCES SHOWN HEREON ARE APPROXIMATE AND HAVE NOT BEEN VERIFIED BY A CURRENT FIELD SURVEY.



www.balzer.cc

Roanoke  
New River Valley  
Richmond  
Staunton  
Harrisonburg

RESIDENTIAL LAND DEVELOPMENT ENGINEERING  
SITE DEVELOPMENT ENGINEERING  
LAND USE PLANNING & ZONING  
LANDSCAPE ARCHITECTURE  
LAND SURVEYING  
ARCHITECTURE  
STRUCTURAL ENGINEERING  
TRANSPORTATION ENGINEERING  
ENVIRONMENTAL & SOIL SCIENCE  
WETLAND DELINEATIONS & STREAM EVALUATIONS

Balzer and Associates, Inc.

80 College Street, Suite H  
Christiansburg, VA 24073  
540-381-4290  
FAX 540-381-4291

OLD BLACKSBURG MIDDLE SCHOOL SITE  
501 SOUTH MAIN STREET

EXISTING PARCEL MAP

MOUNT TABOR MAGISTERIAL DISTRICT  
TOWN OF BLACKSBURG, VIRGINIA

DRAWN BY GLM  
DESIGNED BY  
CHECKED BY SMS  
DATE 10/6/17  
SCALE 1" = 150'  
REVISIONS:  
1. 5/13/19 Approval  
2. 4/1/20 Amend. #1

SHEET NO.  
**Z1**  
JOB NO. B1200098.00

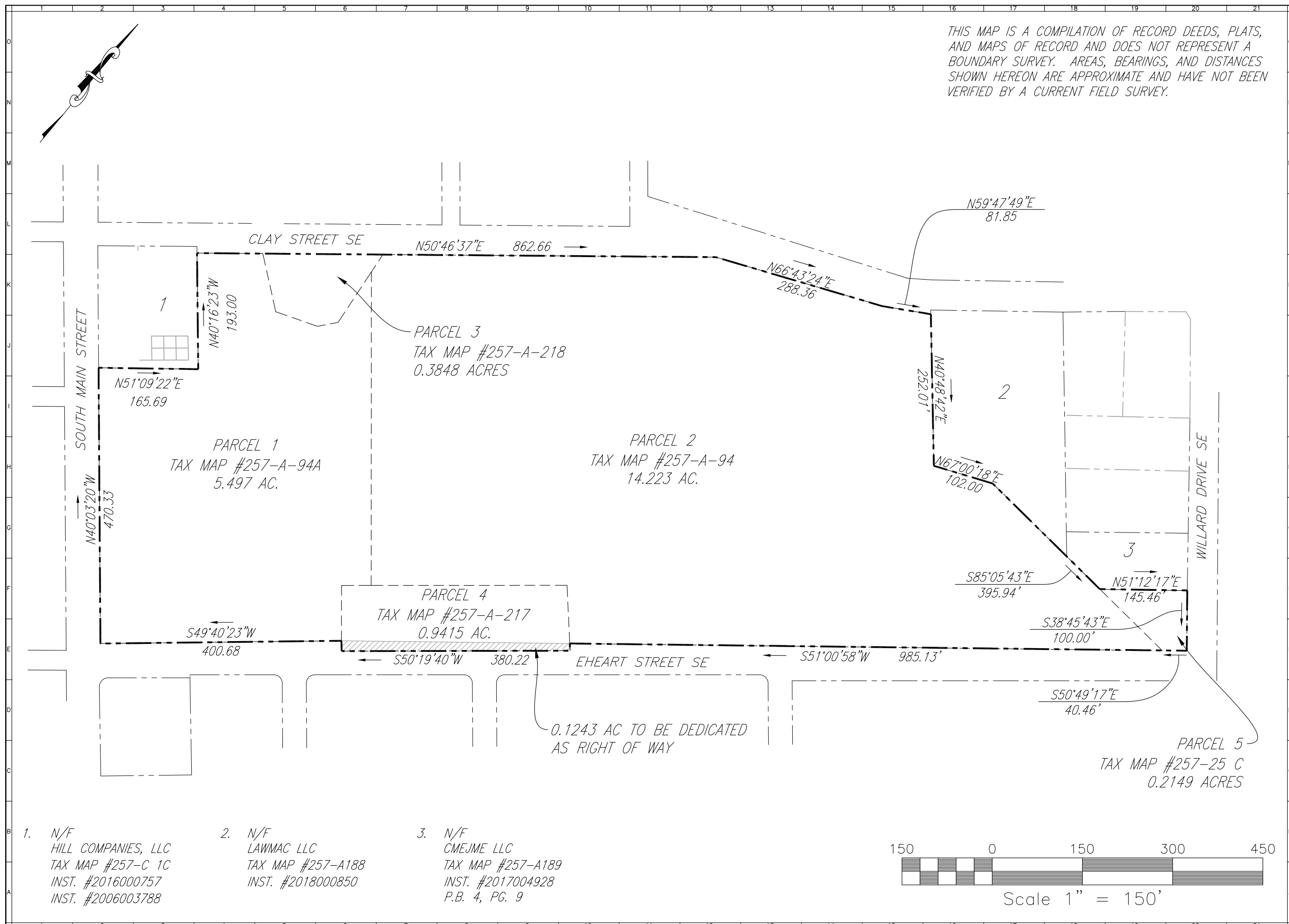

1. N/F  
HILL COMPANIES, LLC  
TAX MAP #257-C 1C  
INST. #2016000757  
INST. #2006003788

2. N/F  
LAWMAC LLC  
TAX MAP #257-A188  
INST. #2018000850

3. N/F  
CMEJME LLC  
TAX MAP #257-A189  
INST. #2017004928  
P.B. 4, PG. 9

**OLD BLACKSBURG MIDDLE SCHOOL SITE**  
501 SOUTH MAIN STREET

**EXISTING CONDITIONS**

MOUNT TABOR MAGISTERIAL DISTRICT  
TOWN OF BLACKSBURG, VIRGINIA

DRAWN BY GLM  
DESIGNED BY  
CHECKED BY SMS  
DATE 10/6/17  
SCALE 1" = 180'

REVISIONS:  
1. 5/13/19 Approval  
2. 4/1/20 Amend. #1

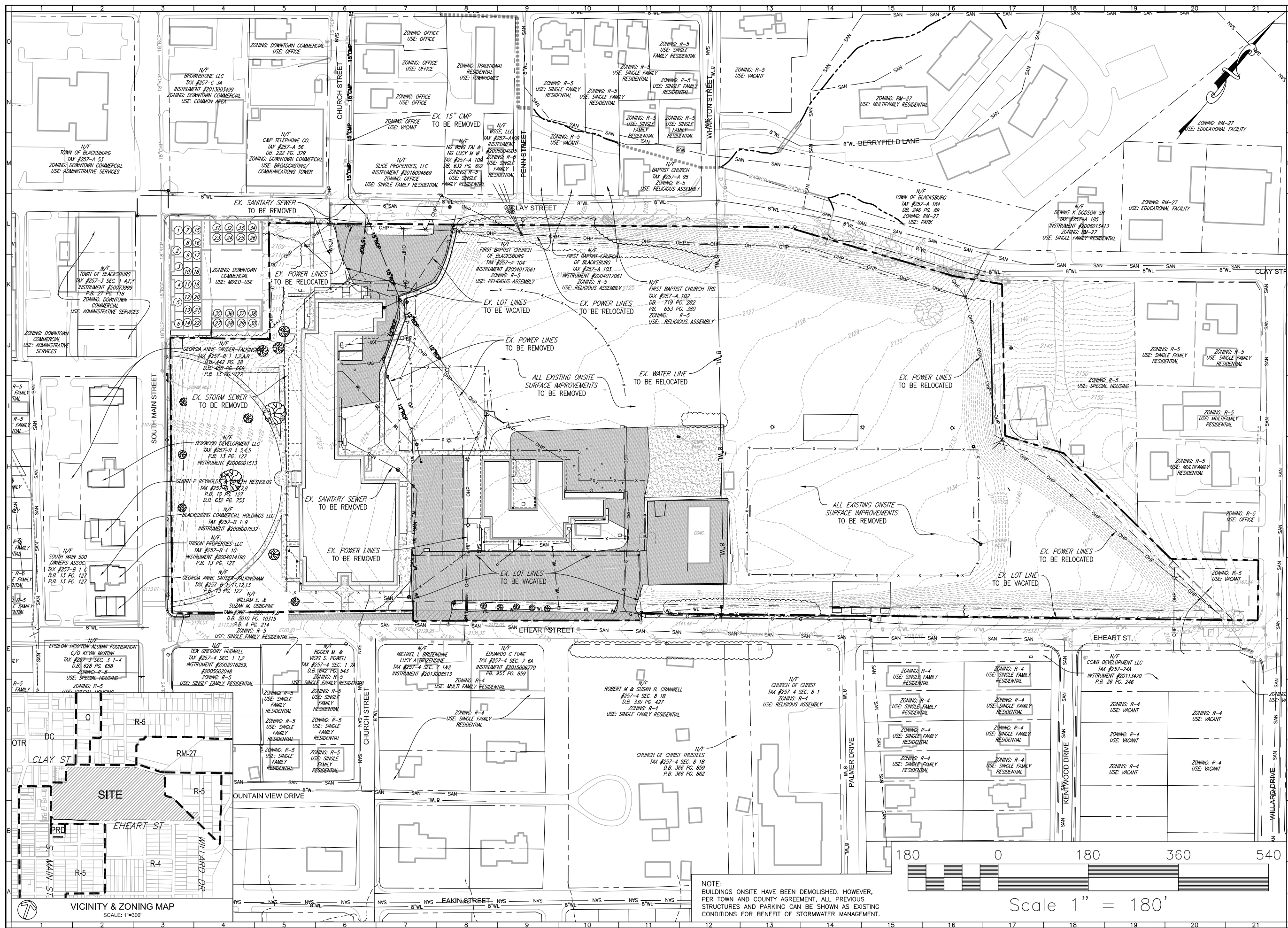

NOTE:  
BUILDINGS ONSITE HAVE BEEN DEMOLISHED, HOWEVER,  
PER TOWN AND COUNTY AGREEMENT, ALL PREVIOUS  
STRUCTURES AND PARKING CAN BE SHOWN AS EXISTING  
CONDITIONS FOR BENEFIT OF STORMWATER MANAGEMENT.

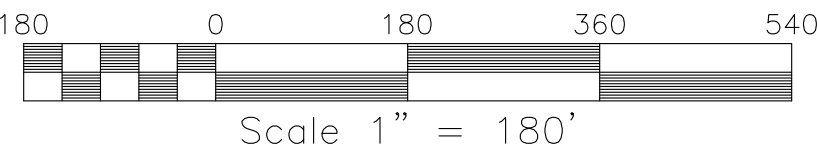

VICINITY & ZONING MAP  
SCALE: 1"=300'

**LEGEND**

- DC ZONING  
10.59 AC
- PRD ZONING  
10.54 AC



www.balzer.cc

Roanoke  
New River Valley  
Richmond  
Staunton  
Harrisonburg

RESIDENTIAL LAND DEVELOPMENT/ENGINEERING  
SITE DEVELOPMENT/ENGINEERING  
LAND USE PLANNING & ZONING  
LANDSCAPE ARCHITECTURE  
LAND SURVEYING  
ARCHITECTURE  
STRUCTURAL ENGINEERING  
TRANSPORTATION ENGINEERING  
ENVIRONMENTAL & SOIL SCIENCE  
WETLAND DELINEATIONS & STREAM EVALUATIONS

**Balzer and Associates, Inc.**  
80 College Street, Suite H  
Christiansburg, VA 24073  
540-381-4290  
FAX 540-381-4291

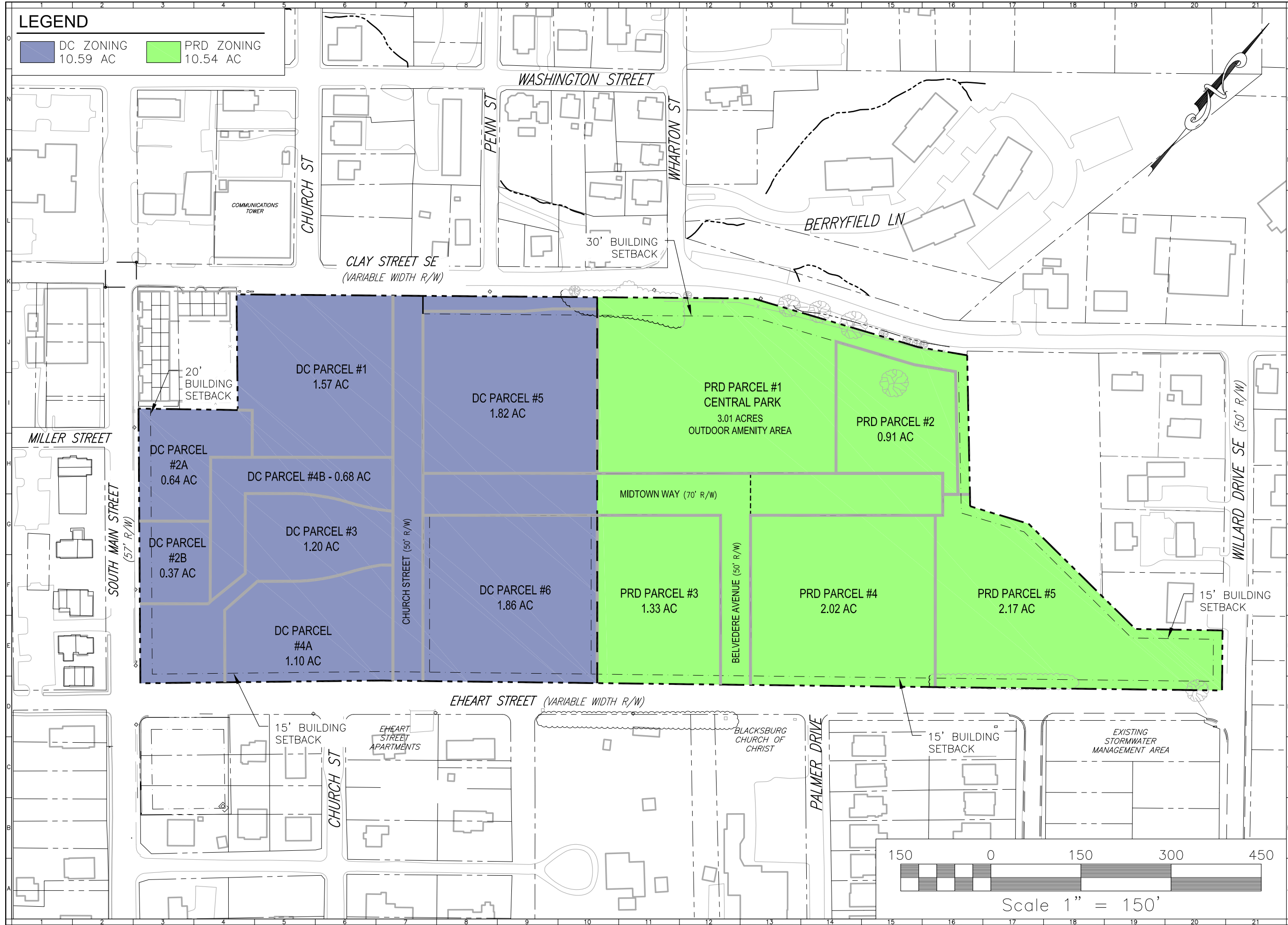

**OLD BLACKSBURG MIDDLE SCHOOL SITE**  
501 SOUTH MAIN STREET  
**ZONING PLAN**  
MOUNT TABOR MAGISTERIAL DISTRICT  
TOWN OF BLACKSBURG, VIRGINIA

DRAWN BY GLM  
DESIGNED BY SMS  
CHECKED BY SMS  
DATE 10/6/17  
SCALE 1"=150'  
REVISIONS:  
1. 5/13/19 Approval  
2. 4/1/20 Amend. #1

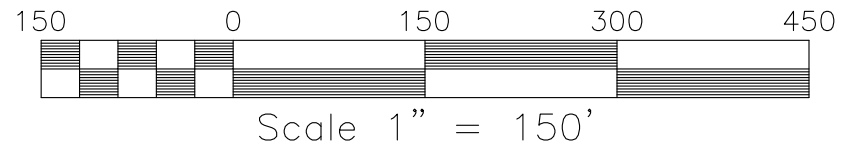

SHEET NO.  
**Z3**  
JOB NO. B1200098.00



REFLECTING TOMORROW

www.balzer.cc  
Roanoke  
New River Valley  
Richmond  
Staunton  
Harrisonburg

RESIDENTIAL LAND DEVELOPMENT ENGINEERING  
SITE DEVELOPMENT ENGINEERING  
LAND USE PLANNING & ZONING  
LANDSCAPE ARCHITECTURE  
LAND SURVEYING  
ARCHITECTURE  
STRUCTURAL ENGINEERING  
TRANSPORTATION ENGINEERING  
ENVIRONMENTAL & SOIL SCIENCE  
WETLAND DELINEATION & STREAM EVALUATIONS

Balzer and Associates, Inc.

80 College Street, Suite H  
Christiansburg, VA 24073  
540-381-4290  
FAX 540-381-4291

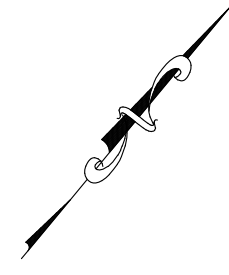
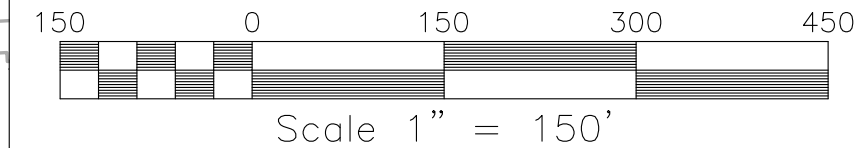
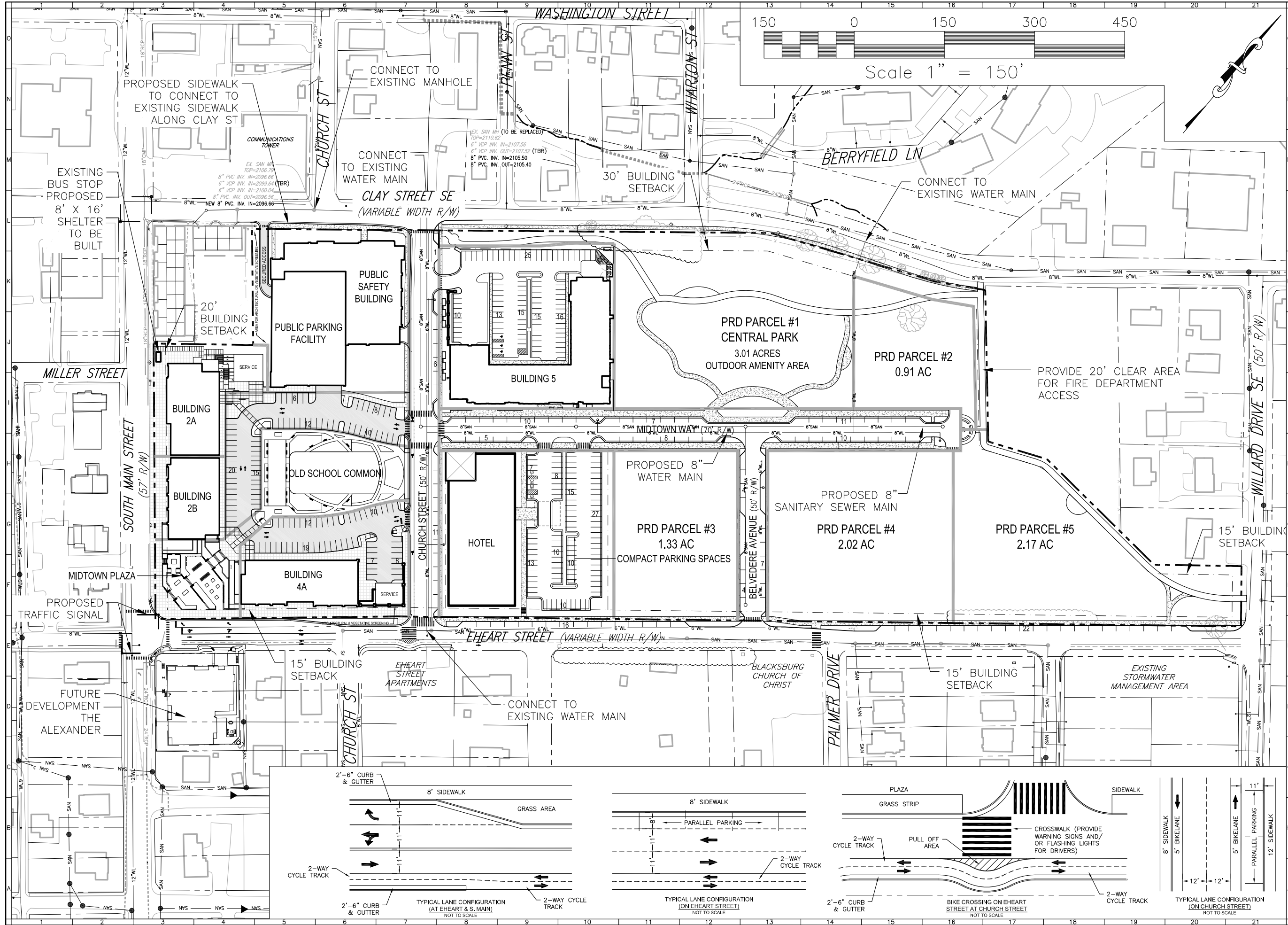

**OLD BLACKSBURG MIDDLE SCHOOL SITE**  
501 SOUTH MAIN STREET  
**OVERALL CONCEPTUAL MASTER PLAN**  
MOUNT TABOR MAGISTERIAL DISTRICT  
TOWN OF BLACKSBURG, VIRGINIA

DRAWN BY GLM  
DESIGNED BY SMS  
CHECKED BY SMS  
DATE 10/6/17  
SCALE 1"=150'





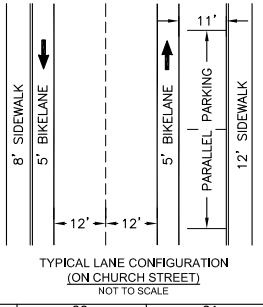
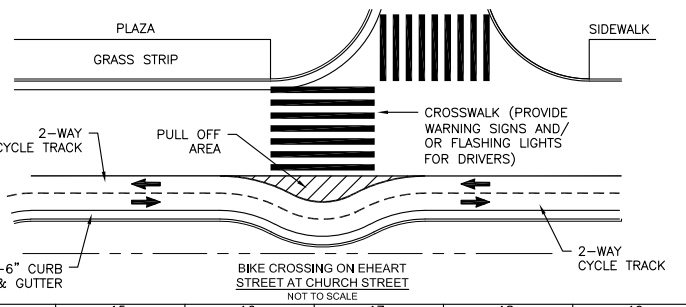
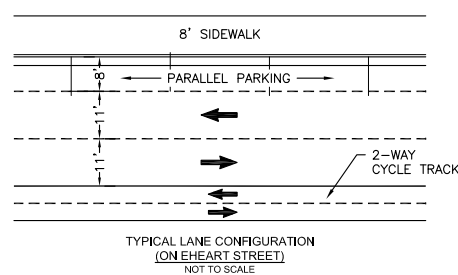
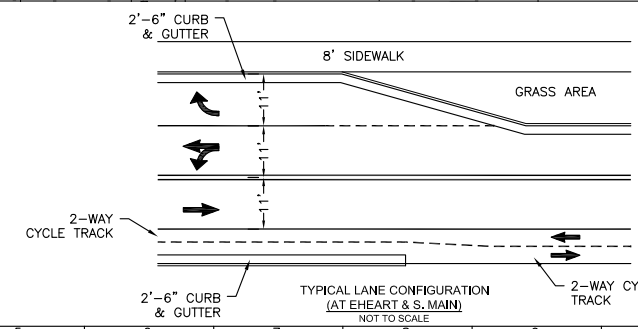





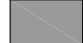

REVISIONS:  
1. 5/13/19 Approval  
2. 4/1/20 Amend. #1

SHEET NO.  
**Z4**  
JOB NO. B1200098.00





**LEGEND**

- |   |                            |   |                   |
|---|----------------------------|---|-------------------|
|  | OLD SCHOOL COMMON          |  | CENTRAL PARK      |
|  | PEDESTRIAN WAY             |  | NEIGHBORHOOD PARK |
|  | MIDTOWN PLAZA              |  | GREEN CORRIDORS   |
|  | MIDTOWN WAY                |   |                   |
|  | MIDTOWN PEDESTRIAN WAY     |  | BIKE TRAIL        |
|  | PEDESTRIAN TRAILS/WALKWAYS |  | PUBLIC SIDEWALKS  |
|  | 10' MULTI-USE TRAIL        |   |                   |

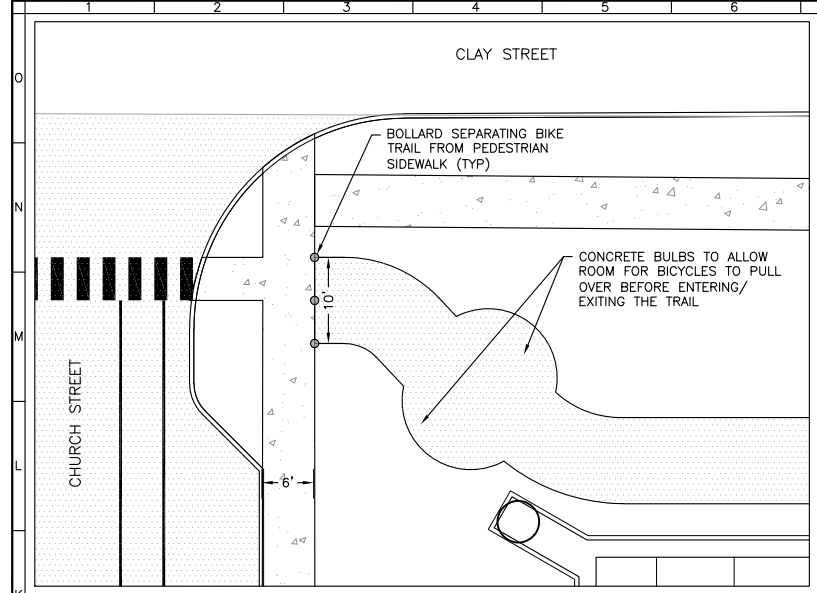

TRAIL CONNECTION TO SIDEWALK AT CHURCH AND CLAY STREETS  
SCALE: 1"=10'

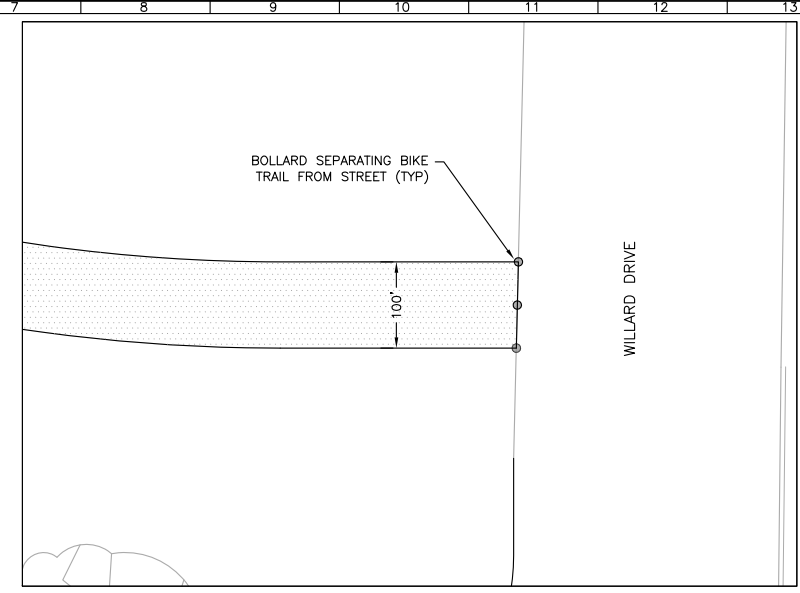

TRAIL CONNECTION TO SIDEWALK AT EHEART STREET AND WILLARD DRIVE  
SCALE: 1"=10'

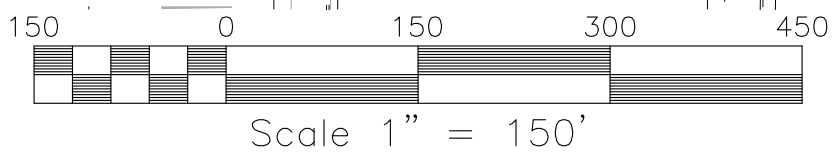
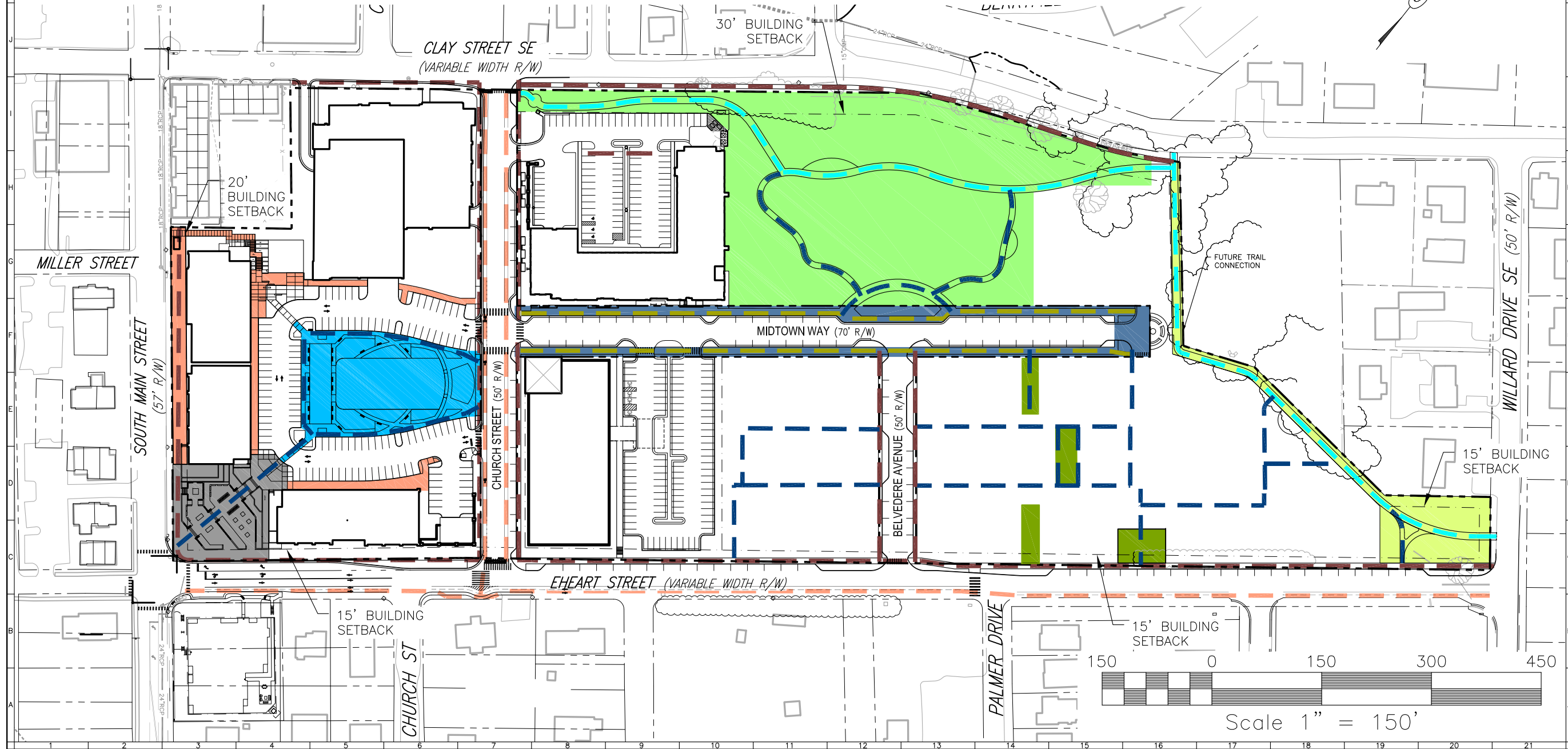

**OLD BLACKSBURG MIDDLE SCHOOL SITE**  
501 SOUTH MAIN STREET

**PROPOSED PARKS & TRAILS**  
MOUNT TABOR MAGISTERIAL DISTRICT  
TOWN OF BLACKSBURG, VIRGINIA

DRAWN BY GLM  
DESIGNED BY SMS  
CHECKED BY SMS  
DATE 10/6/17  
SCALE 1"=150'

REVISIONS:  
1. 5/13/19 Approval  
2. 4/1/20 Amend. #1

**LEGEND**

-  PUBLIC SIDEWALK
-  10' MULTI-USE TRAIL
-  PEDESTRIAN TRAIL/WALKWAY

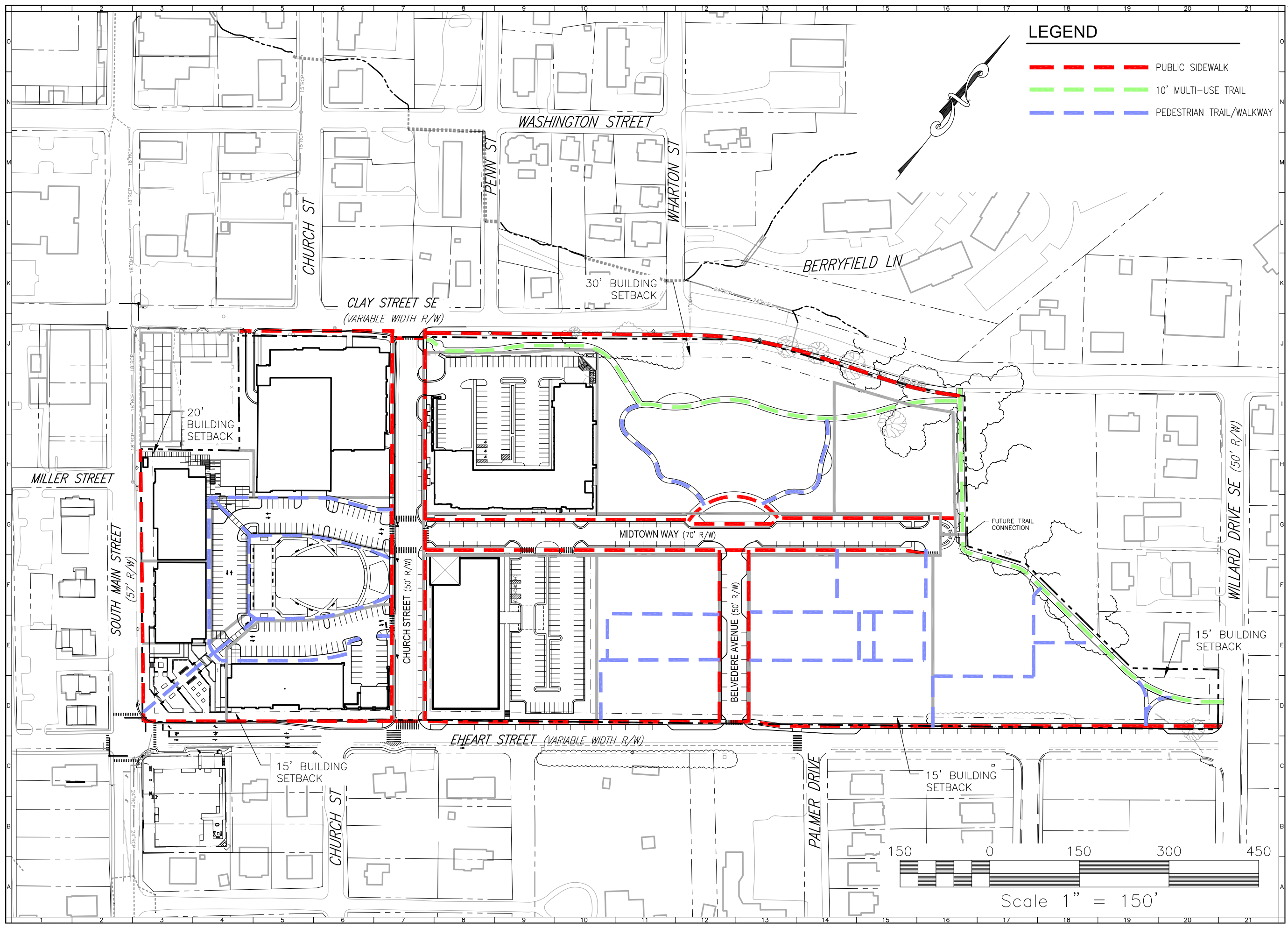
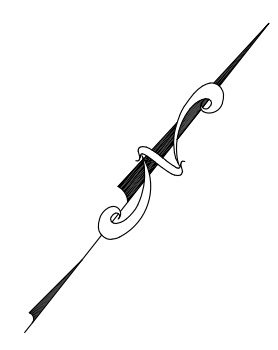

**OLD BLACKSBURG MIDDLE SCHOOL SITE**  
501 SOUTH MAIN STREET  
**PROPOSED SIDEWALK & TRAIL PLAN**  
MOUNT TABOR MAGISTERIAL DISTRICT  
TOWN OF BLACKSBURG, VIRGINIA

DRAWN BY GLM  
DESIGNED BY SMS  
CHECKED BY SMS  
DATE 10/6/17  
SCALE 1"=150'  
REVISIONS:  
1. 5/13/19 Approval  
2. 4/1/20 Amend. #1

**LEGEND**

 DC PUBLIC USE SPACE

 PRD OPEN SPACE

PUBLIC USE AREA=54,260 SF

REQUIRED OPEN SPACE = 20% OF PRD SITE AREA  
= 91,807 SF

PROVIDED OPEN SPACE = 144,864 SF (32%)

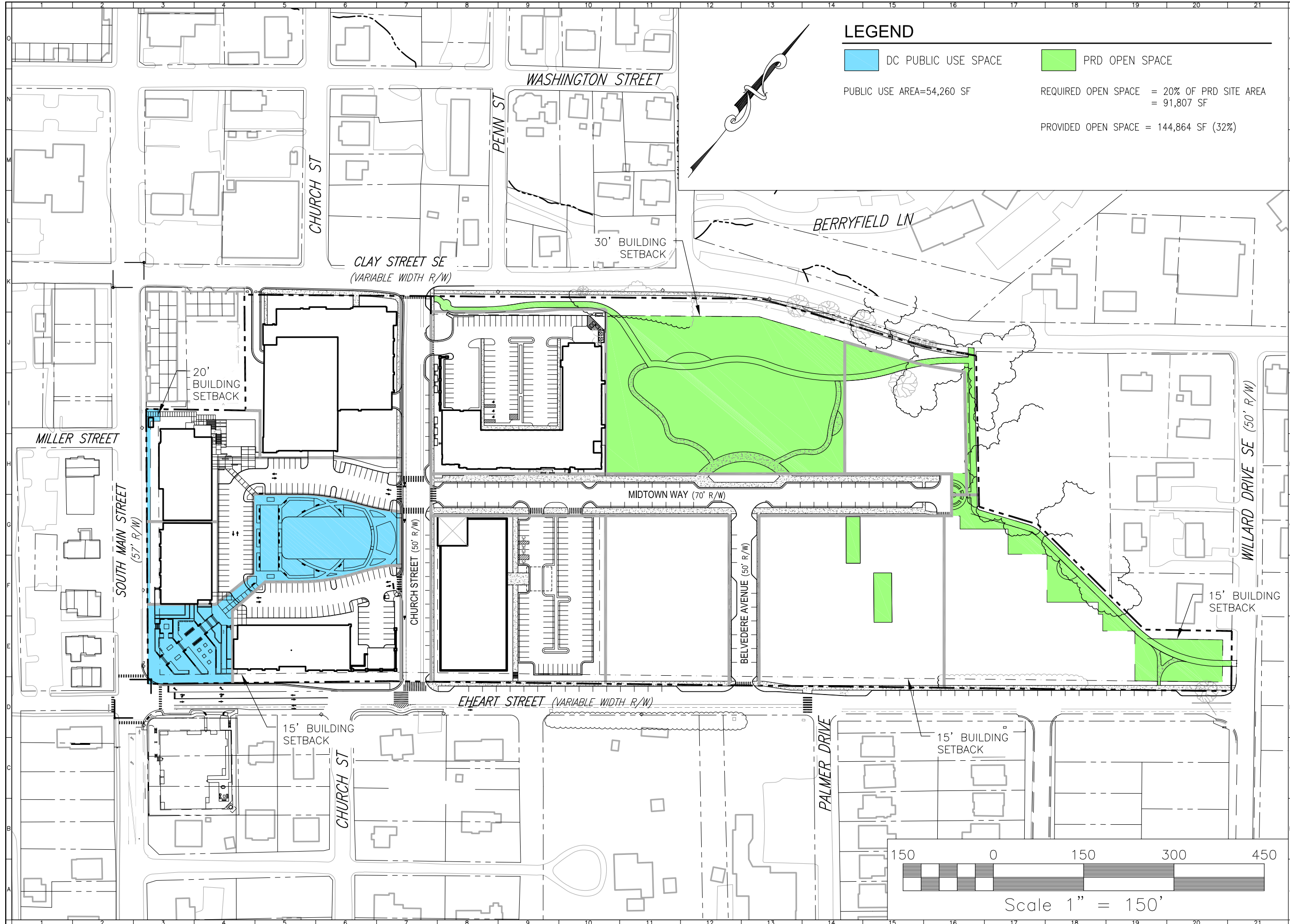
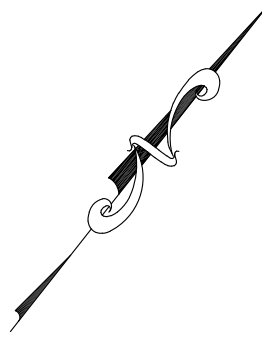

**OLD BLACKSBURG MIDDLE SCHOOL SITE**  
501 SOUTH MAIN STREET

**PROPOSED OPEN SPACE PLAN**

MOUNT TABOR MAGISTERIAL DISTRICT  
TOWN OF BLACKSBURG, VIRGINIA

DRAWN BY GLM  
DESIGNED BY SMS  
CHECKED BY SMS  
DATE 10/6/17  
SCALE 1"=150'

REVISIONS:  
1. 5/13/19 Approval  
2. 4/1/20 Amend. #1

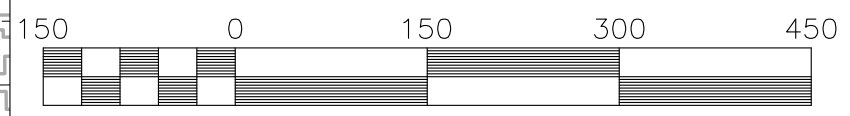

Scale 1" = 150'

SHEET NO.

**27**

JOB NO. B1200098.00



**OLD BLACKSBURG MIDDLE SCHOOL SITE**  
501 SOUTH MAIN STREET  
**PROPOSED INTERSECTION DESIGN**  
MOUNT TABOR MAGISTERIAL DISTRICT  
TOWN OF BLACKSBURG, VIRGINIA

DRAWN BY GLM  
DESIGNED BY SMS  
CHECKED BY SMS  
DATE 10/6/17  
SCALE 1"=40'

REVISIONS:  
1. 5/13/19 Approval  
2. 4/1/20 Amend. #1

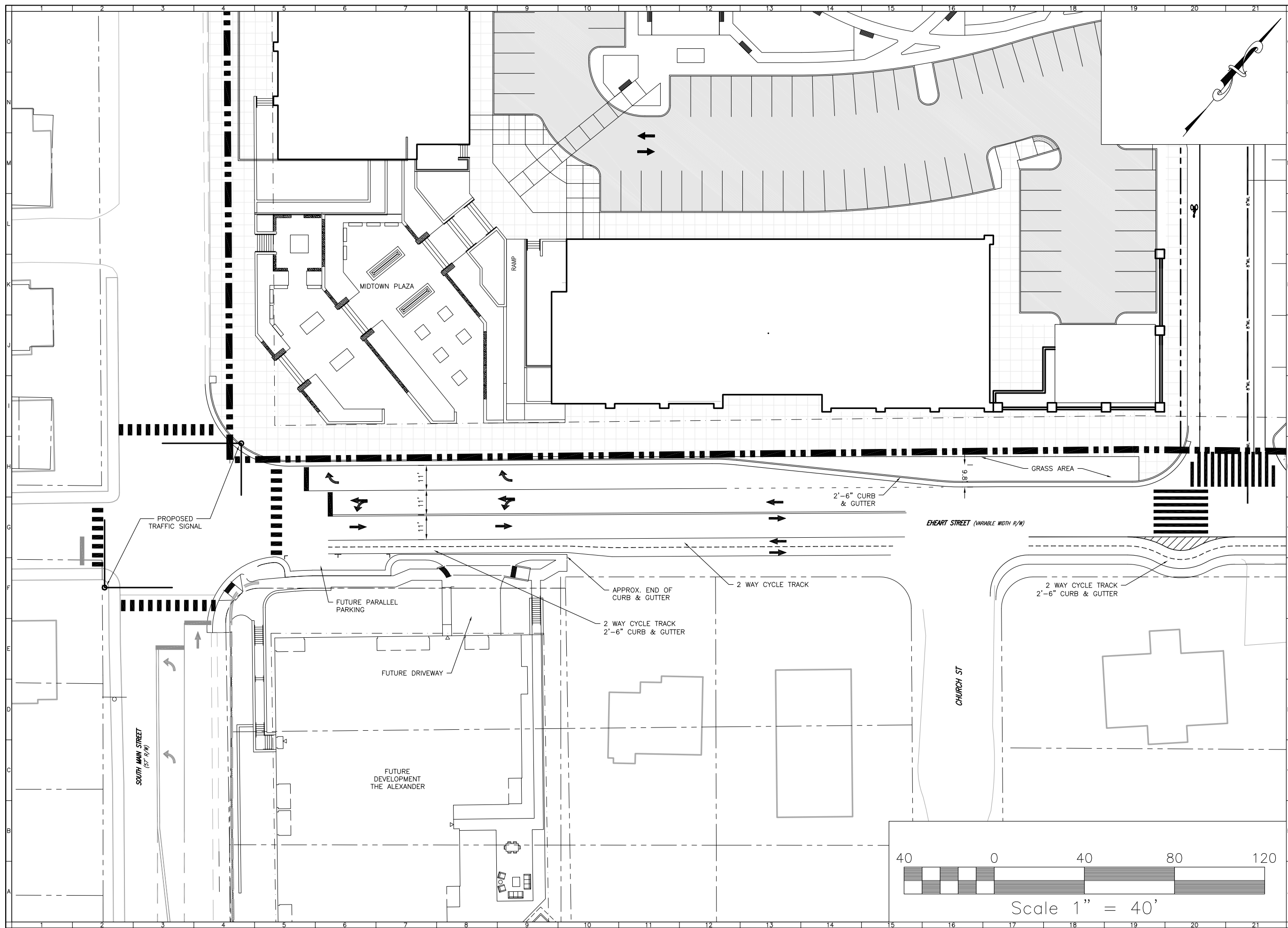



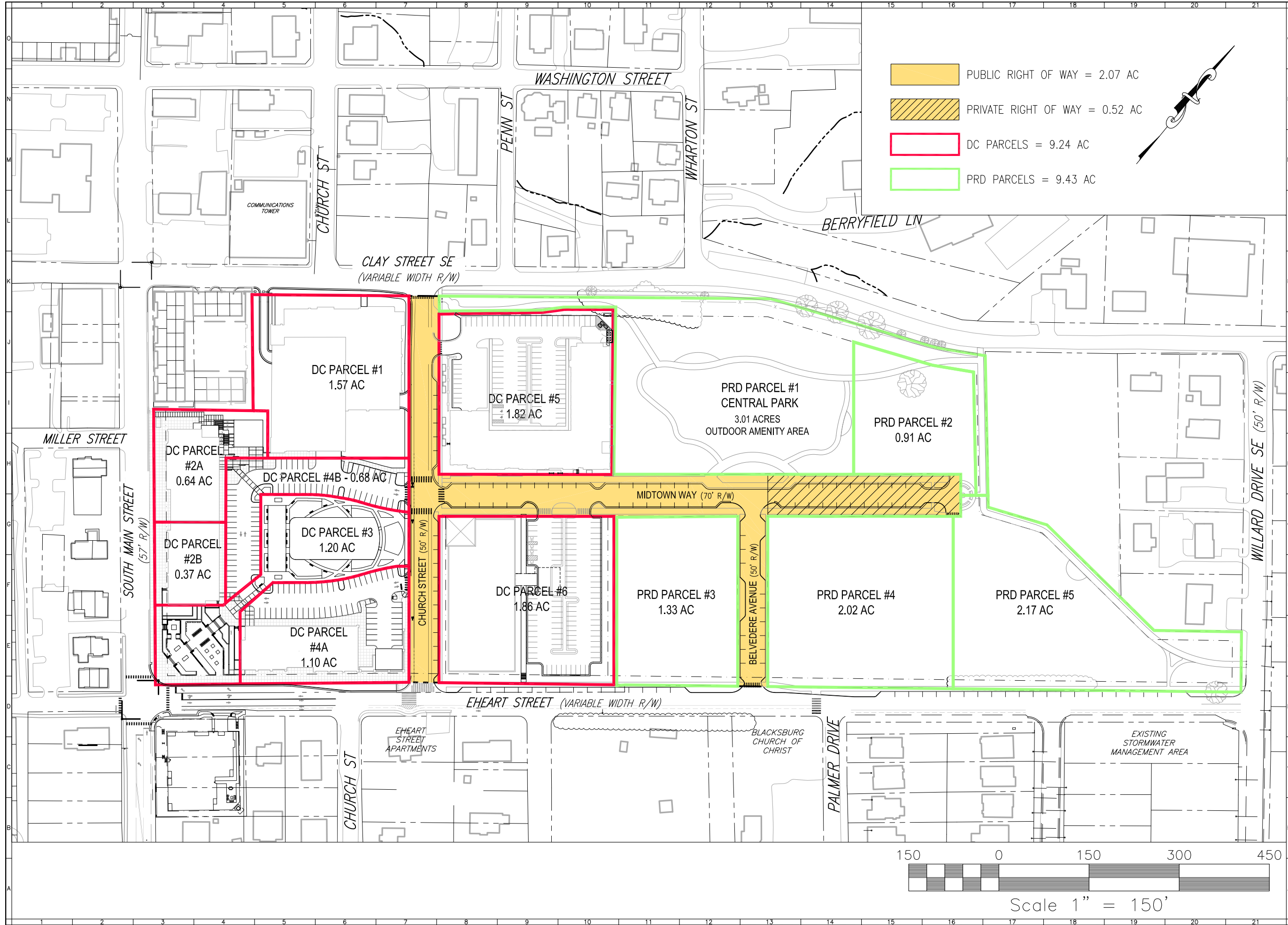

**OLD BLACKSBURG MIDDLE SCHOOL SITE**  
501 SOUTH MAIN STREET

**PROPOSED PARCEL MAP**

MOUNT TABOR MAGISTERIAL DISTRICT  
TOWN OF BLACKSBURG, VIRGINIA

DRAWN BY GLM  
DESIGNED BY SMS  
CHECKED BY SMS  
DATE 10/6/17  
SCALE 1" = 150'

REVISIONS:  
1. 5/13/19 Approval  
2. 4/1/20 Amend. #1

